

REPLACEMENT WEAR PARTS FOR KOMATSU MACHINERY

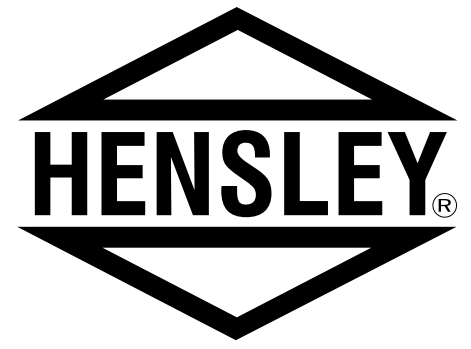

RTB & MINI EXCAVATOR DIRECT REPLACEMENT PARTS

Adapter

Pin w/Snap Ring

Machine Model	<p>20X-70-14151HX 8.5 Lbs. (3.9 Kgs.)</p>	<p>20X-70-00100P</p>
WB140 WB150		
PC 60 PC 75 PC 80 PC 90		

Tooth Types

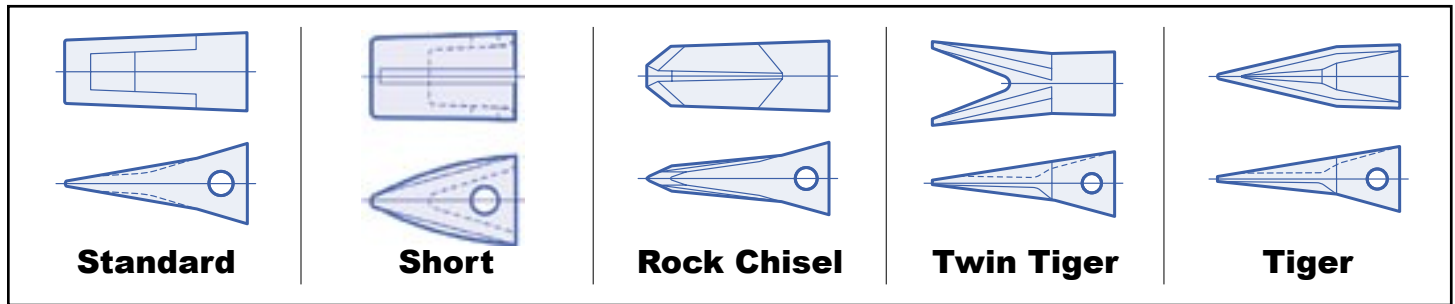

Tooth Dimensions-Inches (MM)

Machine Model	Part Number	Tooth Types	Tooth Fastener			Weight		
				A	B	Lbs.	Kgs.	
WB140 WB150	20X-70-14160HX	Standard	20X-70-00100P	7 (178)	2-1/2 (64)	5.3	2.4	
	20X-70-14160SHX	Short		5 (127)	2-3/4	4.8	2.2	
	20X-70-14160RC	Rock Chisel		7-3/4 (197)	2-17/32 (64)	6.6	3.0	
	20X-70-14160WT	Twin Tiger		8-1/2 (216)	3-13/16 (97)	6.1	2.8	
	T20X-70-14160	Tiger		8-1/2 (216)	1/4 (6)	5.0	2.3	
PC 60 PC 75 PC 80 PC 90	20X-70-14160HX	Standard	20X-70-00100P	7 (178)	2-1/2 (64)	5.3	2.4	
	20X-70-14160RC	Rock Chisel		7-3/4 (197)	2-17/32 (64)	6.6	3.0	
	20X-70-14160WT	Twin Tiger		8-1/2 (216)	3-13/16 (97)	6.1	2.8	
	T20X-70-14160	Tiger		8-1/2 (216)	1/4 (6)	5.0	2.3	

EXCAVATORS

Adapters

<p>205-939-1270HX 21.8 Lbs. (9.9 Kgs.)</p> <p>NOT A DIRECT REPLACEMENT This adapter fits a 1-1/4" lip with a 30° bevel.</p>	<p>205-939-1580HX 25.0 Lbs. (11.3 Kgs.)</p> <p>NOT A DIRECT REPLACEMENT This adapter fits a 1-1/2" lip with a 30° bevel.</p>	<p>207-939-1580HX 37.5 Lbs. (17.0 Kgs.)</p> <p>NOT A DIRECT REPLACEMENT This adapter fits a 1-1/2" lip with a 30° bevel.</p>	<p>208-939-3120AHX 62.0 Lbs. (28.1 Kgs.)</p> <p>Fits PC400</p>
---------------------------------------------------------------------------------------------------------------------------------------------------	----------------------------------------------------------------------------------------------------------------------------------------------------	----------------------------------------------------------------------------------------------------------------------------------------------------	----------------------------------------------------------------------------------

Direct Replacement Teeth

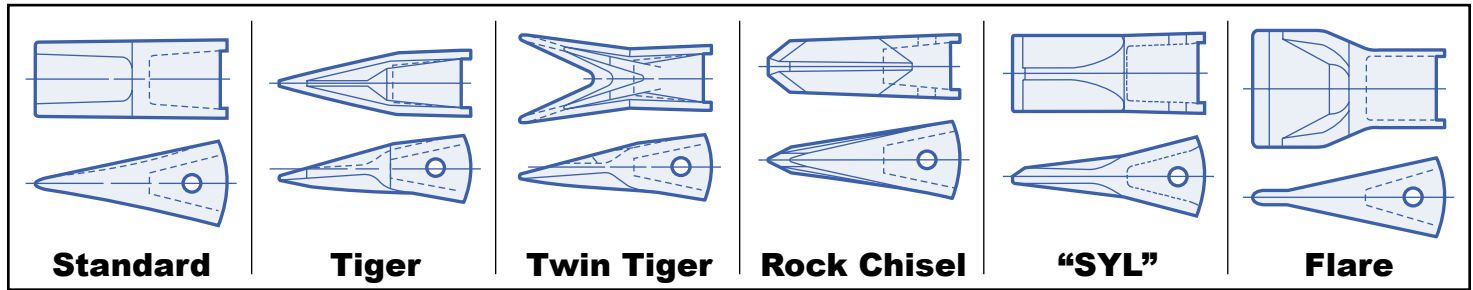

Tooth Dimensions- Inches (MM)

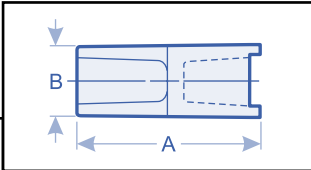
Machine Model	Part Number	Tooth Types	Tooth Fastener			Weight	
				A	B	Lbs.	Kgs.
PC 100	205-70-19570HX	Standard	092-44-02496P	8-3/4 (222)	3-1/8 (79)	9.7	4.4
	T205-70-19570	Tiger		10-5/8 (270)	--	10.6	4.8
PC 120	205-70-19570WT	Twin Tiger		10-5/8 (270)	4-3/4 (121)	12.7	5.8
PC 150	205-70-19570RC	Rock Chisel		10-11/16 (271)	3-11/16 (94)	13.8	6.3
	205-70-19570SYL	SYL		10-1/4 (260)	3-11/16 (94)	12.5	5.7
PC 200	205-70-19570F	Flare		9-1/2 (241)	6-1/2 (163)	13.2	6.0
PC 220	207-70-14151HX	Standard	175-78-21740P	9-5/8 (244)	3-3/4 (95)	16.0	7.3
	T207-70-14151	Tiger		11-1/2 (292)	--	16.0	7.3
PC 280	207-70-14151WT	Twin Tiger		11-1/2 (292)	5-3/4 (146)	19.3	8.8
PC 300	207-70-14151RC	Rock Chisel		11-3/8 (289)	4-1/4 (108)	21.0	9.5
PC 360	207-70-14151SYL	SYL		11 (279)	4-1/2 (114)	17.3	7.9
	207-70-14151F	Flare	10-1/4 (260)	7-1/2 (191)	20.4	9.3	
PC 400	208-70-14152HX	Standard	426-847-2310P	10-11/16 (271)	4-1/2 (114)	23.3	10.6
	208-70-14270HX	Standard		12-1/2 (318)	4-3/4 (121)	32.2	14.6
	T208-70-14152	Tiger		14 (356)	--	27.7	12.6
	208-70-14152WT	Twin Tiger		14 (356)	6-3/4 (171)	30.1	13.7
	208-70-14152RC	Rock Chisel		13-1/2 (343)	4-11/16 (119)	34.0	15.4
	208-70-14152SYL	SYL	13-1/4 (337)	5-1/8 (130)	26.4	12.0	
	208-70-14152F	Flare	11-1/2 (292)	9 (229)	30.0	13.6	
PC 650	209-70-54210HX	Standard	209-70-5420P	13-3/4 (349)	5-5/8 (143)	63.0	28.6
PC 1000	21N-72-14290HX	Standard	21N-72-14330P	16-5/8 (422)	6-3/8 (162)	93.5	42.4

Dimensions: Inches (MM)

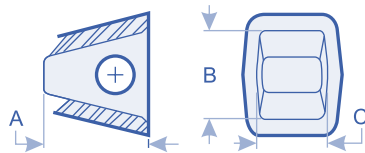

Tooth Pocket

Dimensions: Inches (MM)

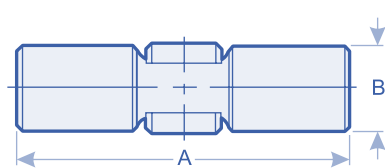

Pins

Pin Part Number

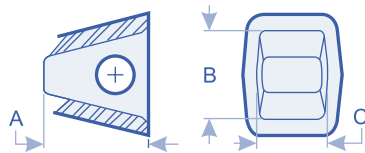
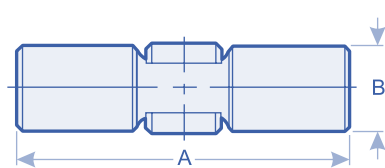
Machine Model				Pin Part Number		
	A	B	C		A	B
PC 100 PC 120 PC 150 PC 200	4-5/16 (110)	3-1/8 (79)	2-15/16 (75)	092-44-02496P	3-25/32 (96)	31/32 (25) dia.
PC 220 PC 280 PC 300 PC 360	4-9/16 (116)	3-3/8 (86)	3-11/16 (94)	175-78-21740P	4-5/8 (117)	31/32 (25) dia.
PC 400	5-13/16 (148)	3-5/8 (92)	4-11/32 (110)	426-847-2310P	5-21/32 (143)	1-5/32 (29) dia.
PC 650	6-7/8 (175)	5-13/32 (137)	5-1/16 (129)	209-70-54240P	6-5/8 (168)	1-13/32 (36) dia.
PC 1000	9-1/2 (241)	7-9/32 (185)	4-7/8 (124)	21N-72-14330P	6-1/2 (165)	1-9/16 (40) dia.

EXCAVATORS - CONTINUED

Vertical Edge Protector

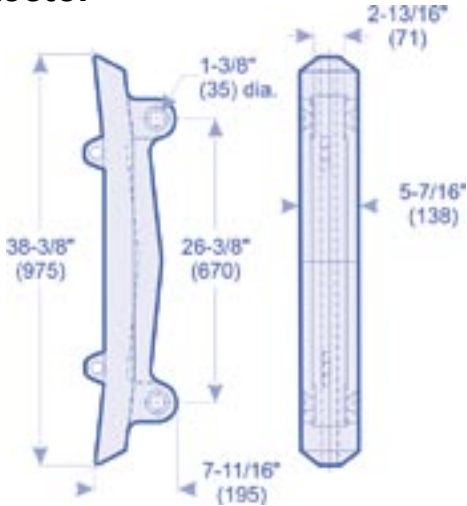

K3814 (PC1800)

149.0 lbs. (67.6 kgs.)

Bolt-on Adapters for Komatsu Loaders

Loader Model/ Adapter Position	Hensley Part Number	Hensley Tooth Series*	Replaces Komatsu Part Number	Replaces Esco Part Number
WA120 center left hand right hand	140X135 (140X160) 141X135 (141X160) 142X135 (142X160)	135 (160)	417-847-1140 417-847-1120 417-847-1130	416-847-A110 (18 conical) 416-847-A120 (18 conical) 416-847-A130 (18 conical)
WA180 center left hand right hand	120X235 (120X220) 121X235 (121X220) 122X235 (122X220)	235 (220)	418-847-1120 418-847-1160 418-847-1170	5780-V19 5781L-V19 5781R-V19
WA250 / WA320 center left hand right hand	111X295 112X295 113X295	295	419-847-1111 419-847-1121 419-847-1131	4798-V23 5763L-V23 5763R-V23
WA380 / WA420 / WA450 center left hand right hand	142X335 145X335 146X335	335	423-847-1111 423-847-1121 423-847-1131	5764-V23 & 5764-V29 5765L-V23 & 5765L-V29 5765R-V23 & 5765R-V29
D66S center left hand right hand	142X335 143X335 144X335	335	142-70-12230 142-70-12240 142-70-12250	5764-V23 & 5764-V29
WA500 center left hand right hand	191X385 192X385 193X385	385	425-847-1191 425-847-1211 425-847-1221	5750-V39 5765L-V39 5765R-V39

*See appropriate series brochure for tooth details.

Hensley Replacement Adapters

WA120

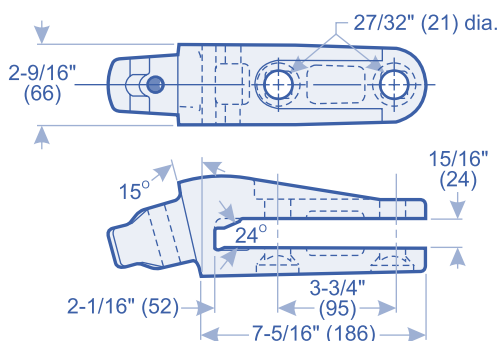

140X135 (center)

8.6 lbs. (3.9 kgs.)

Requires (2) A34-300 plow bolt assemblies

135 series adapters

**Parabolic adapters
are still available.**
(140X160, 141X160 & 142X160)

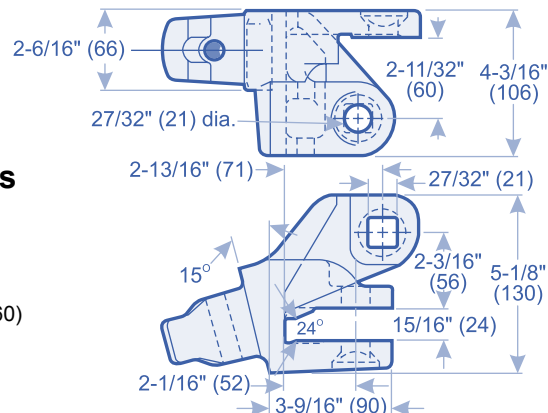

142X135 (RH shown) 141X135 (LH opposite)

9.5 lbs. (4.3 kgs.)

Requires (1) A34-300 & (1) A34-200 plow bolt assemblies

WA180

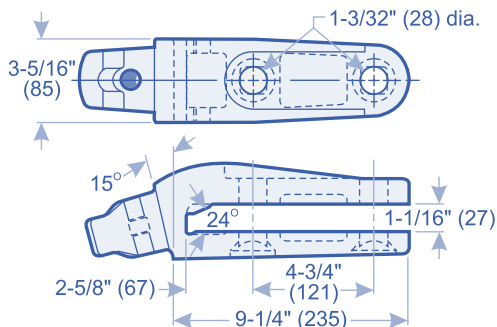

120X235 (center)

19.7 lbs. (8.9 kgs.)

Requires (2) A10-312 plow bolt assemblies

235 series adapters

**Parabolic adapters
are still available.**
(120X220, 121X220 & 122X220)

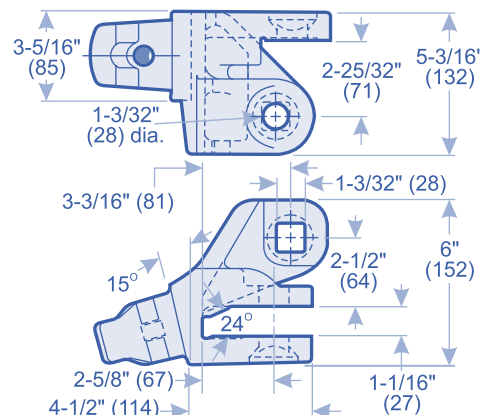

122X235 (RH shown) 121X235 (LH opposite)

16.9 lbs. (7.7 kgs.)

Requires (1) A10-200 & (1) A10-312 plow bolt assemblies

LOADERS - CONTINUED

Hensley Replacement Adapters- continued

WA250 / WA320

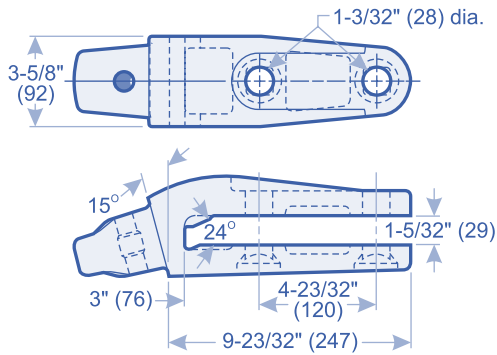

111X295 (center)

23.7 lbs. (10.8 kgs.)

Requires (2) A10-334 plow bolt assemblies

295 series adapters

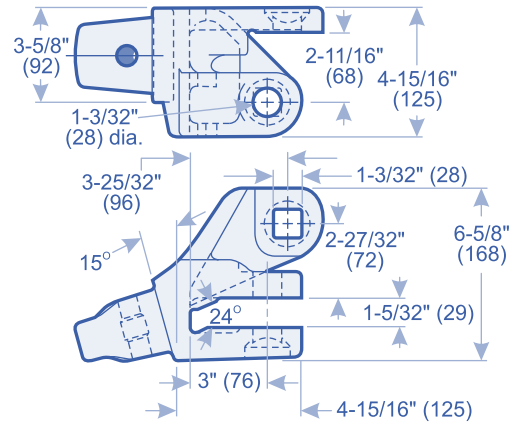

113X295 (RH shown) **112X295** (LH opposite)

21.3 lbs. (9.7 kgs.)

Requires (1) A10-334 & (1) A10-200 plow bolt assemblies

WA380 / WA420 / WA450

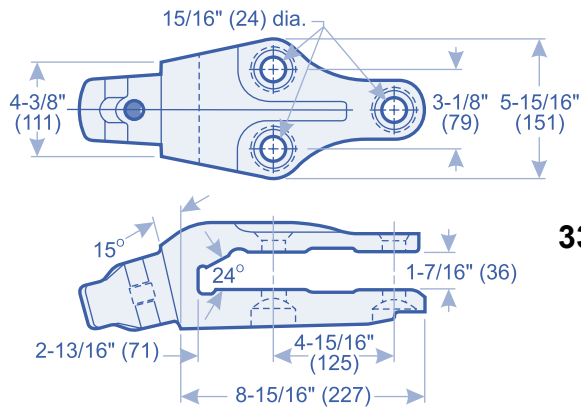

142X335 (center)

31.1 lbs. (14.1 kgs.)

Requires (3) A78-400 plow bolt assemblies

335 series adapters

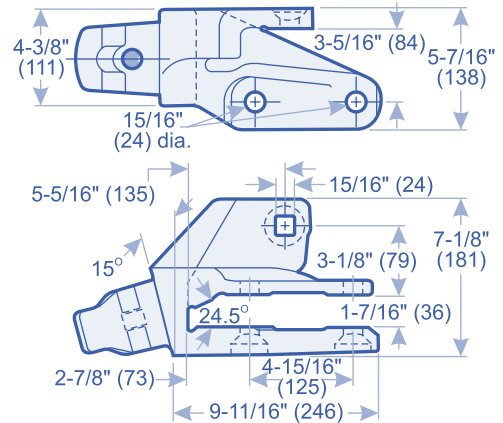

146X335 (RH shown) **145X335** (LH opposite)

33.3 lbs. (15.1 kgs.)

Requires (3) A78-400 plow bolt assemblies

D66S

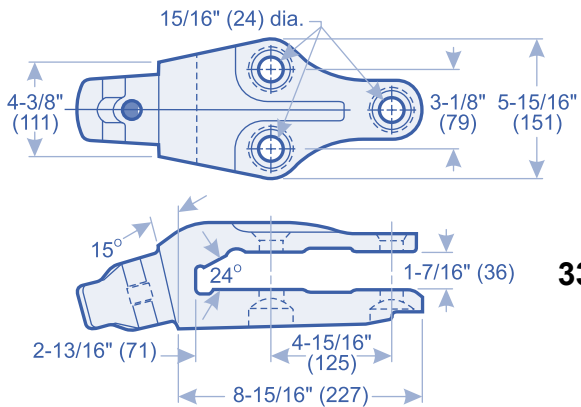

142X335 (center)

31.1 lbs. (14.1 kgs.)

Requires (3) A78-400 plow bolt assemblies

335 series adapters

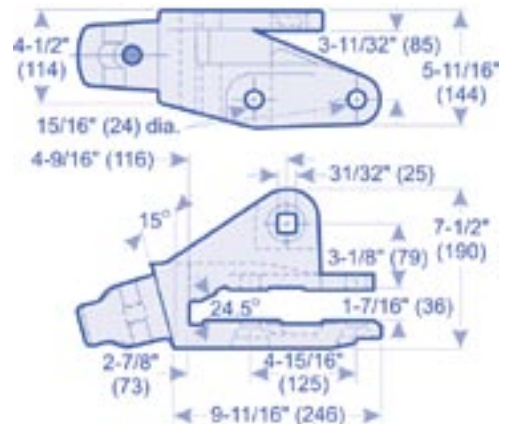

144X335 (RH shown) **143X335** (LH opposite)

34.6 lbs. (15.7 kgs.)

Requires (3) A78-400 plow bolt assemblies

Hensley Replacement Adapters - continued

WA500

191X385 (center)
54.0 lbs. (24.5 kgs.)
Requires (3) A10-412 plow bolt assemblies

385 series adapters

193X385 (RH shown) 192X385 (LH opposite)
59.0 lbs. (26.8 kgs.)
Requires (2) A10-412 & (1) A114-300 plow bolt assemblies

Direct Replacement Teeth

Short Sharp **Standard** **Rock Penetrator** **Bolt-On 1 Pc. Tooth & Adapter**

Tooth Dimensions- Inches (MM)

Machine Model	Part Number	Tooth Types	Tooth Fastener	Diagram		Weight	
				A	B	Lbs.	Kgs.
WA350-470	423-847-1140RP2	Rock Penetrator	175-78-21740P	12-1/2 (317)	4-1/8 (105)	28.2	12.8
WA500 WA600	426-847-1110HX	Standard	426-847-2310P	11-3/8 (289)	4-1/4 (108)	27.0	12.3
	426-847-1110RP2	Rock Penetrator	426-847-1130P	13-3/4 (349)	5 (127)	47.0	21.3
	426-847-1110RP3	Rock Penetrator	426-847-1130P	13-13/16 (351)	5-1/8 (130)	57.0	25.9
WA600	426-70-13311HX	Bolt-On 1 Pc.	N/A	26 (660)	4-7/8 (124)	103.0	46.7
WA700 WA800	427-70-13731HX	Short Sharp	427-70-13790P	13-7/8 (353)	5-9/16 (142)	64.0	29.0
	427-70-13780RP3	Rock Penetrator	427-70-13790P	16-1/4 (413)	6-1/2 (166)	103.0	46.7

Machine Model	Dimensions: Inches (MM)			Pin Part Number	Dimensions: Inches (MM)	
	A	B	C		A	B
WA350-470	4-9/16 (116)	3-3/8 (86)	3-11/16 (94)	175-78-21740P	4-5/8 (117)	31/32 (25) dia.
WA500 WA600	4-3/4 (121)	4-9/32 (109)	4-5/16 (110)	426-847-2310P	5-21/32 (143)	1-5/32 (29) dia.
WA600	No Pocket; Bolt-On 1 pc.			No Pin; Bolt-On 1 pc.		
WA700 WA800	5-9/32 (135)	5-3/16 (132)	4-25/32 (122)	427-70-13790P	6-5/8 (169)	1-5/32 (29) dia.

LOADERS - CONTINUED

Hensley Bolt-On Heel Plates

428-70-1225MBO (WA700)

231.0 lbs. (104.9 kgs.)

Requires (4) A10-412 plow bolt assemblies

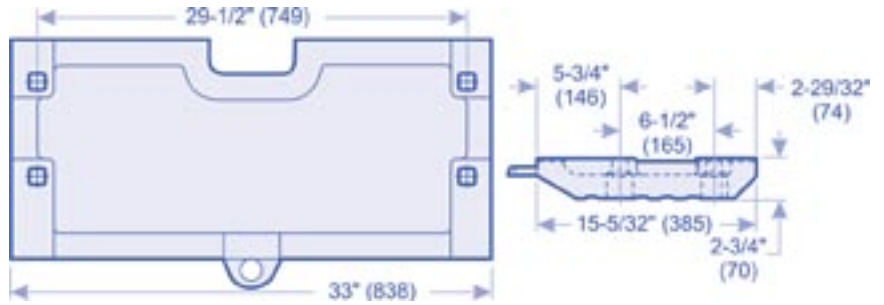

WA8003HP (WA800)

216.0 lbs. (98.1 kgs.)

Requires (X) XXXXX plow bolt assemblies

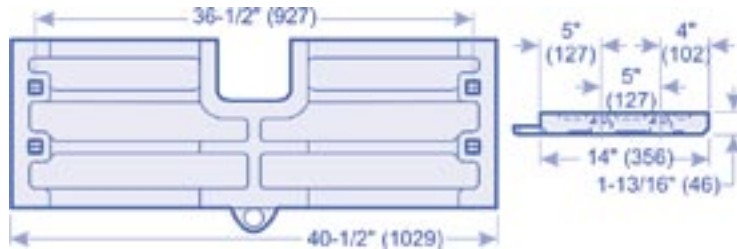

Hensley Half Arrow Bolt-On Segments

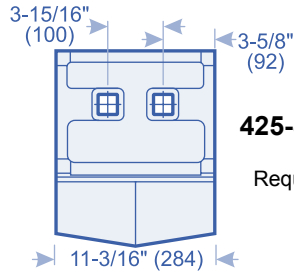

425-838-A110NR (WA500)

44.5 lbs. (20.2 kgs.)

Requires (2) A10-400 plow bolt assemblies each

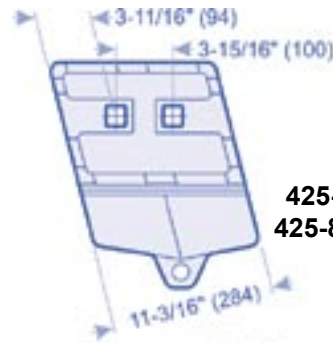

425-838-A110RNR (WA500) shown 425-838-A110LNR (WA500) opposite

54.0 lbs. (24.5 kgs.)

Requires (2) A10-400 plow bolt assemblies each

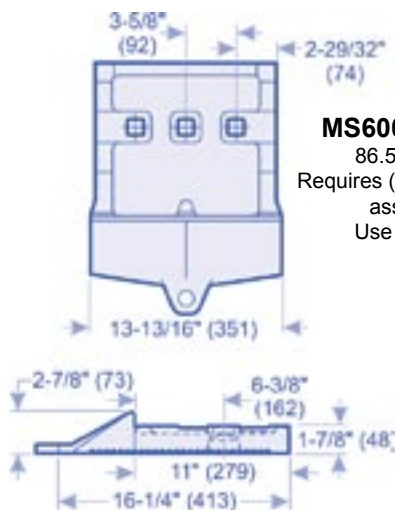
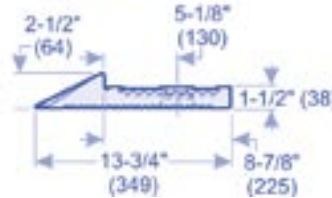
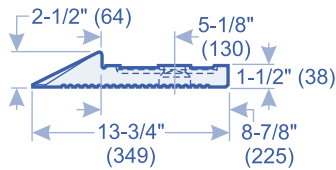

MS600CNR (WA600)

86.5 lbs. (39.0 kgs.)

Requires (3) A114-400 plow bolt assemblies each
Use with RP1 teeth.

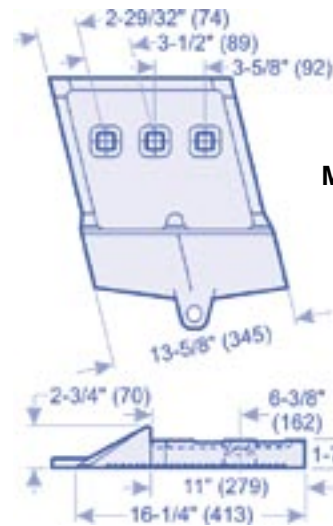

MS600RNR (WA600) shown MS600LNR (WA600) opposite

87.0 lbs. (39.5 kgs.)

Requires (3) A114-400 plow bolt assemblies each
Use with RP1 teeth.

Hensley Half Arrow Bolt-On Segments - continued

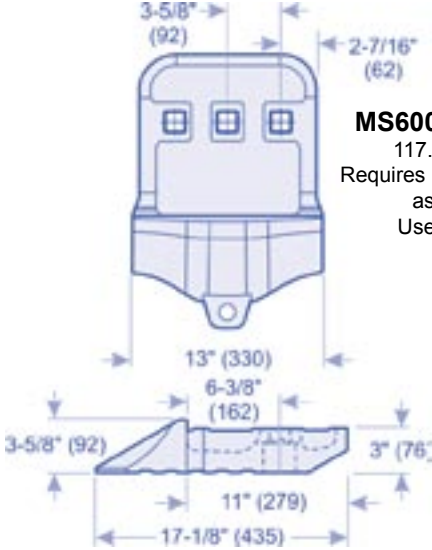

MS600CNRH (WA600)
117.5 lbs. (53.3 kgs.)
Requires (3) A114-400 plow bolt assemblies each
Use with RP2 teeth.

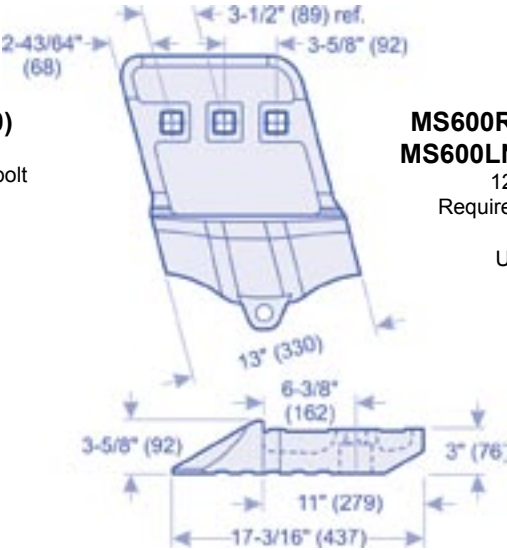

MS600RNRH (WA600) shown MS600LNRH (WA600) opposite
122.5 lbs. (55.6 kgs.)
Requires (3) A114-400 plow bolt assemblies each
Use with RP2 teeth.

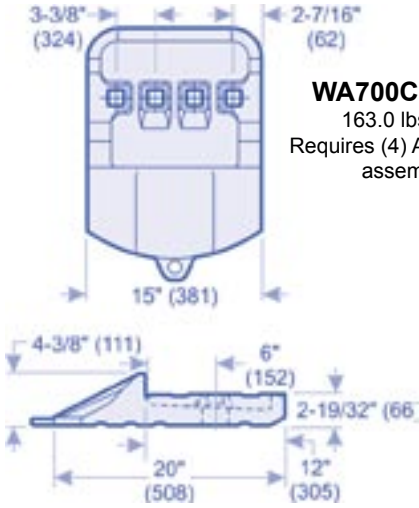

WA700CNR (WA700)
163.0 lbs. (74.0 kgs.)
Requires (4) A114-412 plow bolt assemblies each

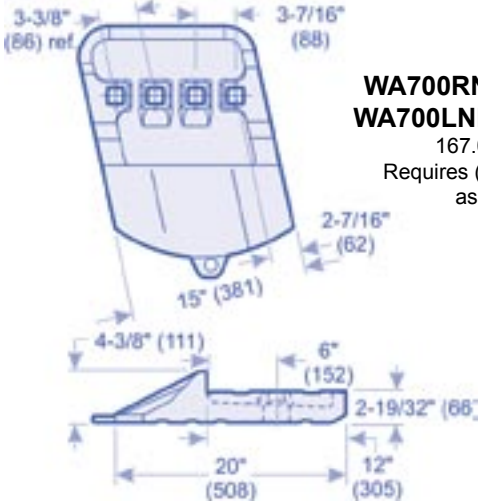

WA700RNR (WA700) shown WA700LNR (WA700) opposite
167.0 lbs. (75.8 kgs.)
Requires (4) A114-412 plow bolt assemblies each

LOADERS - CONTINUED

Hensley Top Covers

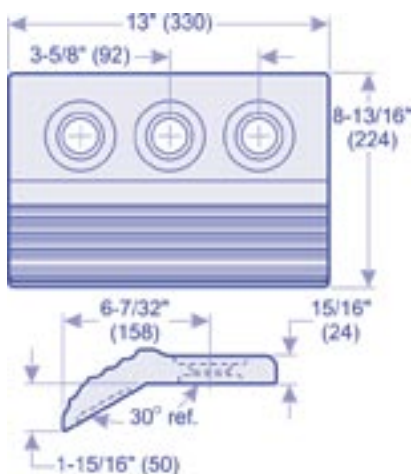

WA600-TCC (WA600)

33.5 lbs. (15.2 kgs.)

For use with MS600CNRH segments.

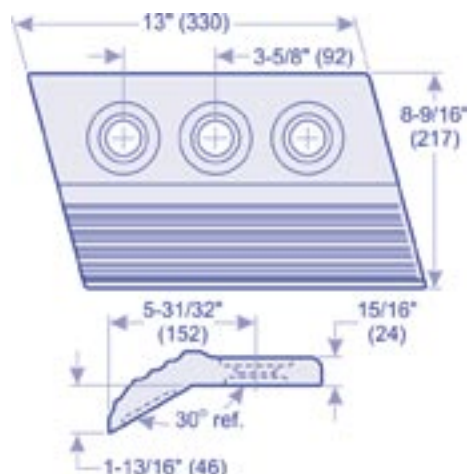

**WA600-TCR (WA600) shown
WA600-TCL (WA600) opposite**

36.5 lbs. (16.6 kgs.)

For use with MS600RNRH and MS600LNRH segments

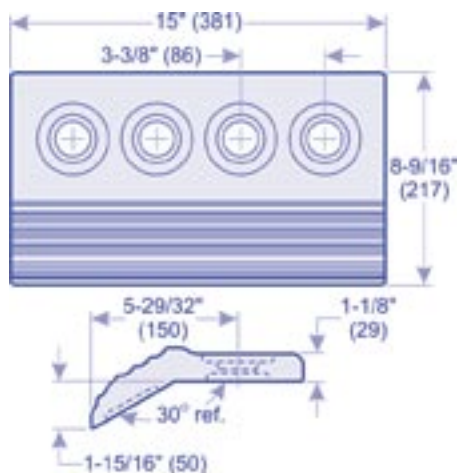

WA700-TCC (WA700)

36.7 lbs. (16.7 kgs.)

For use with WA700CNR segments

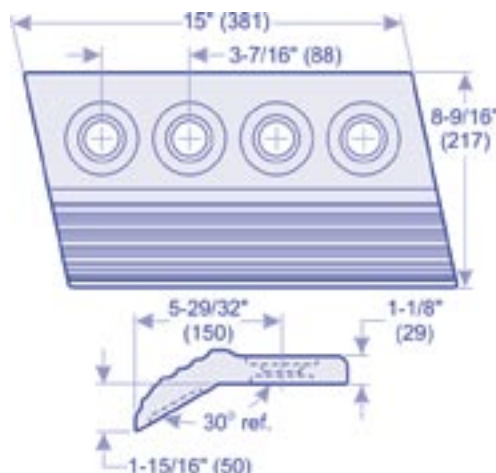

**WA700-TCR (WA700) shown
WA700-TCL (WA700) opposite**

37.2 lbs. (16.9 kgs.)

For use with WA700RNR and WA700LNR segments

TOP COVER PLOW BOLT ASSEMBLIES*

MACHINE (LIP THICKNESS)	PLOW BOLT ASSEMBLY	ASSEMBLY HARDWARE PART NUMBERS	HARDWARE DESCRIPTION	BOLT LENGTH (BOLT DIAMETER)	BOLT THREAD LENGTH (THREADS PER INCH)	TORQUE RECOMMENDATIONS	
						ft-lbs	Nm
WA600 (2-1/2")	AC114600TC	PB114600	1-1/4"-7X6" plow bolt	6" (1-1/4")	3-1/2" (7)	1,700 ± 220	2,3000 ± 300
		N114C	1-1/4" hex cone nut	-	-	-	-
N114		1-1/4" hex nut grade 8	-	-	-	-	
114LW		1-1/4" lock washer	-	-	-	-	
WA700 (2-1/2")							

*Plow bolt assembly information based on required bolt length and bolt thread length.

Hensley Half Arrow Bolt-On Edges

Model	Center Edge	# Req'd.	Bolt/Nut Assemblies	End Edge	# Req'd.	Bolt/Nut Assemblies
WA380-5	423-815-2210NRHX	4	(2) ea. A78-300	421-815-2220NRHX	2	(3) ea. A78-300
WA400	424-815-2210NR	2	(4) ea. A78-300	424-815-2220NR	2	(3) ea. A78-300
WA420-1 S/N 10001-20001	421-70-12122CNR	1	(6) ea. A78-314	RH: 421-70-12122RNR LH: 421-70-12122LNR	1 1	(6) ea. A78-314
WA450-1 S/N 10001-20001	421-70-12122CNR	1	(6) ea. A78-314	RH: 421-70-12320RNR LH: 421-70-12320LNR	1 1	(6) ea. A78-314
WA450-3 WA470	421-815-1211CNR RH: 421-815-1211RCNR LH: 421-815-1211LCNR	1 1 1	(6) ea. A10-312 (4) ea. A10-312 (4) ea. A10-312	421-815-1221NR	2	(4) ea. A10-312
WA470-5	423-815-2211NRHX	5	(2) ea. A78-300	421-815-2220NRHX	2	(3) ea. A78-300
WA500-1 S/N 10001-19999	425-815-1110CNR	3	(4) ea. A10-400	RH: 425-815-1120RNR LH: 425-815-1120LNR	1 1	(2) ea. A10-400
WA500-1 From S/N 20001 WA500-3	RH: 425-815-2210RNR LH: 425-815-2210LNR	1 1	(4) ea. A10-400	425-815-1320NRHX	2	(4) ea. A10-400
WA500-3	425-815-1510CNRHX LH/RH: 425-815-1510RLNRHX	1 2	(4) ea. A10-400 (4) ea. A10-400	425-815-1520NRHX	2	(2) ea. A10-400
WA600-1/WA600-3	426-815-1110NRHX	3	(4) ea. A138-400	426-815-1130NRHX	2	(4) ea. A138-400

421-815-2220NRHX

WA380-5

421-815-2220NRHX

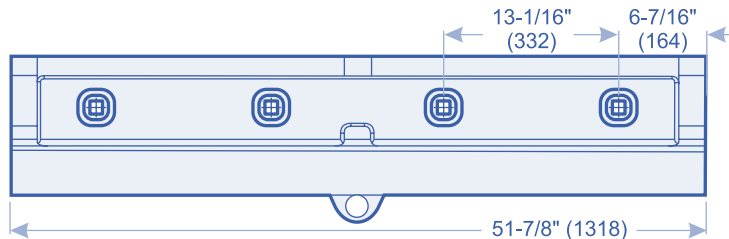
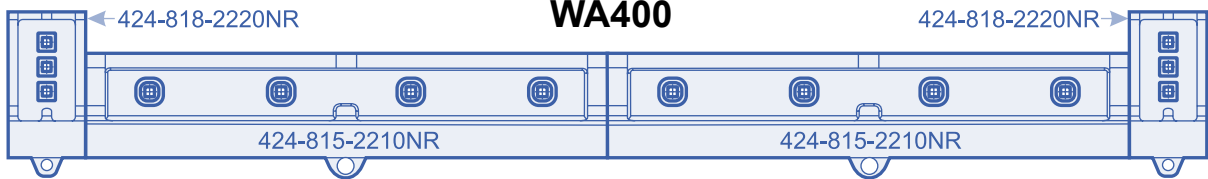
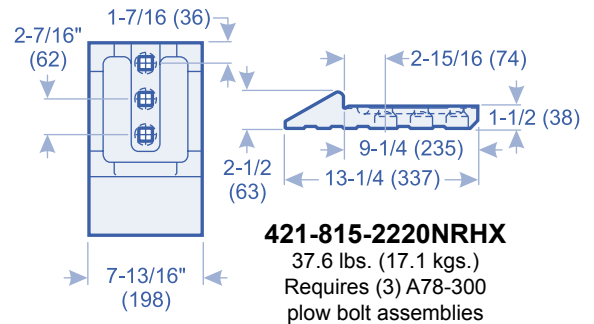
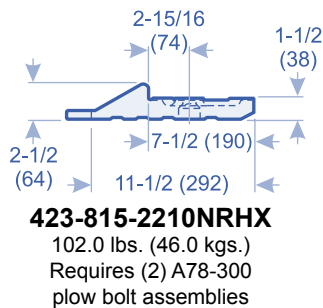
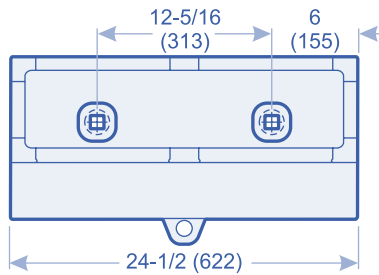
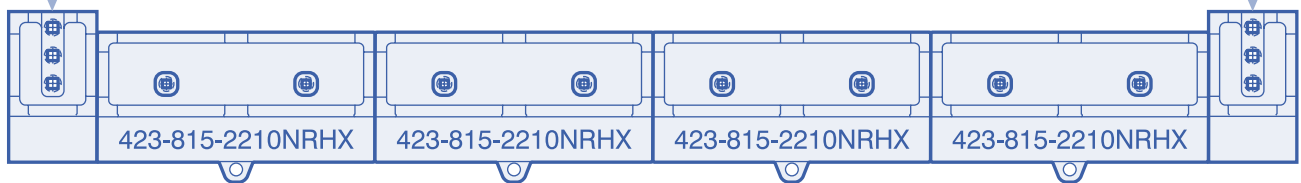

424-815-2210NR
186.0 lbs. (84.4 kgs.)
Requires (4) A78-300 plow bolt assemblies

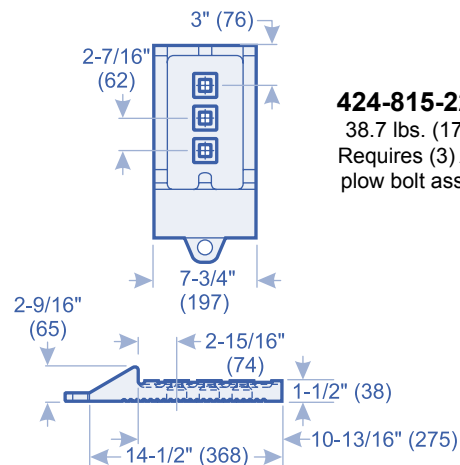
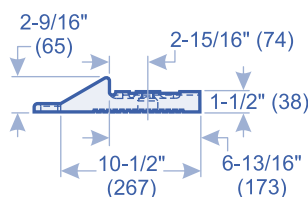

424-818-2220NR
38.7 lbs. (17.6 kgs.)
Requires (3) A78-300
plow bolt assemblies

LOADERS - CONTINUED

Hensley Half Arrow Bolt-On Edges - continued

WA420-1 (S/N 10001 - 20001)

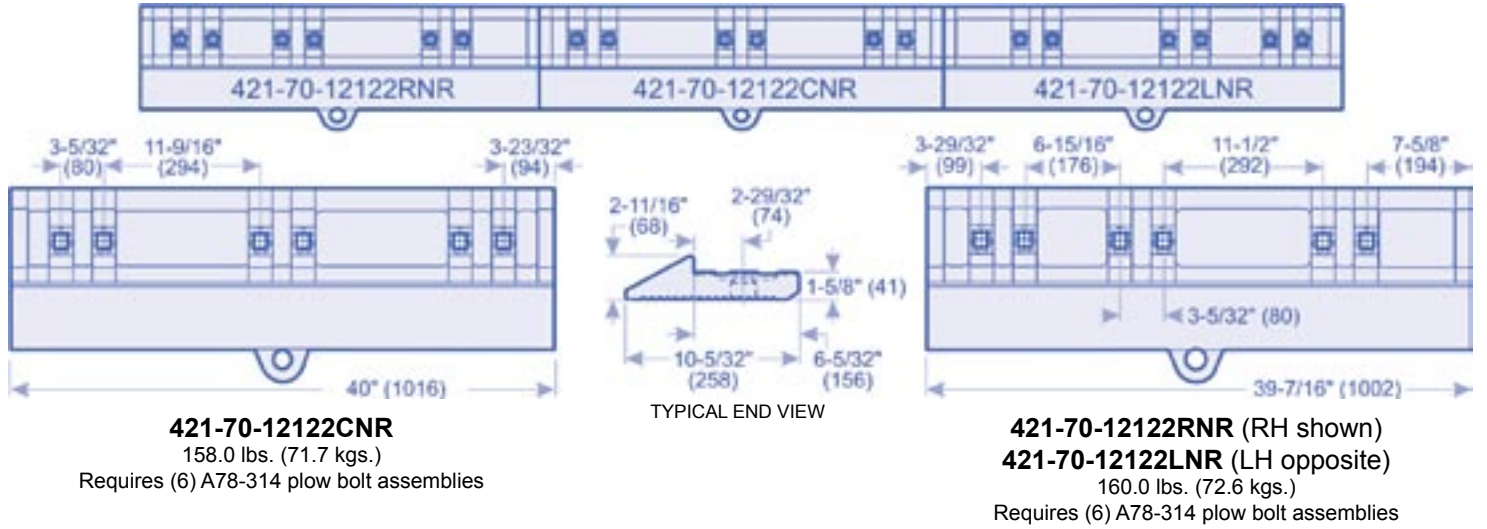

WA450-1 (S/N 10001 - 20001)

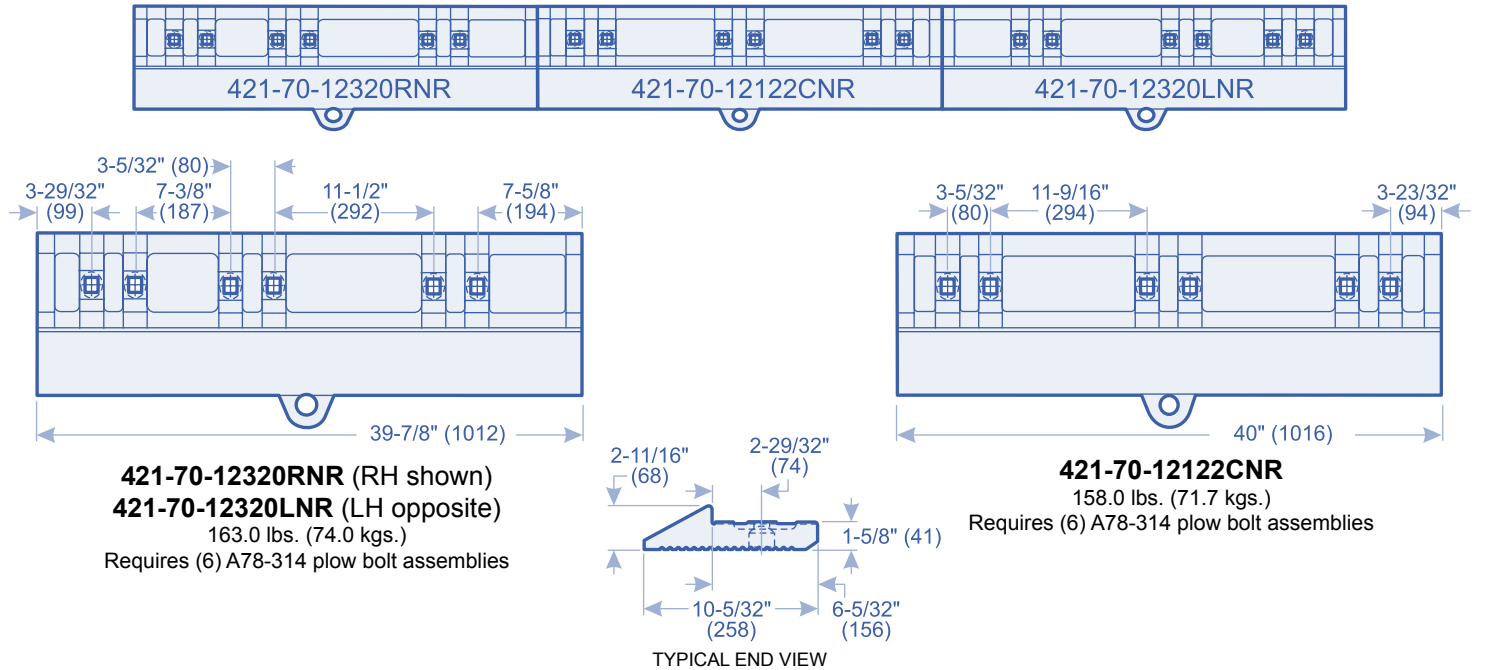

LOADERS - CONTINUED

Hensley Half Arrow Bolt-On Edges - continued

WA450-3 / WA470

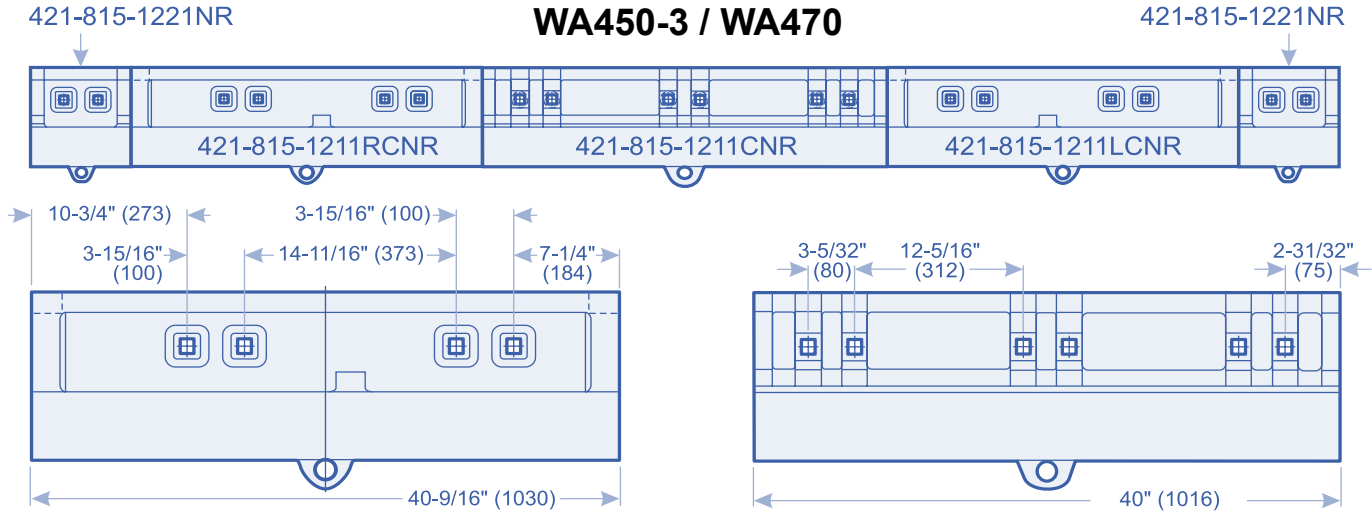

421-815-1211RCNR (RH shown)
421-815-1211LCNR (LH opposite)
 110.0 lbs. (50.4 kgs.)
 Requires (4) A78-312 plow bolt assemblies each

421-815-1211CNR
 144.5 lbs. (65.6 kgs.)
 Requires (6) A78-312 plow bolt assemblies

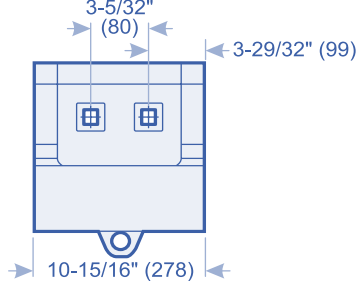

421-815-1221NR
 42.0 lbs. (19.0 kgs.)
 Requires (2) A78-312 plow bolt assemblies each

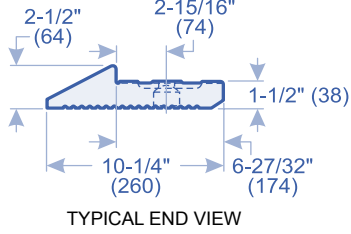

WA470-5

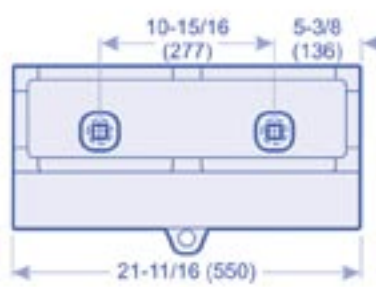

421-815-2211NRHX
 88.0 lbs. (40.0 kgs.)
 Requires (2) A78-300 plow bolt assemblies

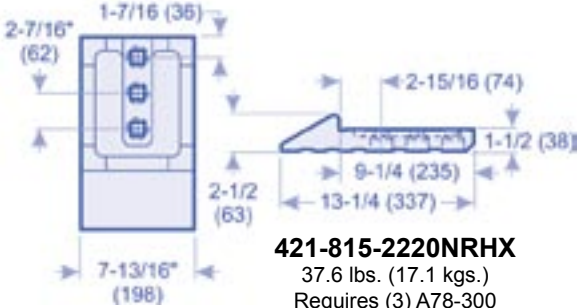

421-815-2220NRHX
 37.6 lbs. (17.1 kgs.)
 Requires (3) A78-300 plow bolt assemblies

LOADERS - CONTINUED

Hensley Half Arrow Bolt-On Edges - continued

WA500-1 (S/N 10001 - 19999)

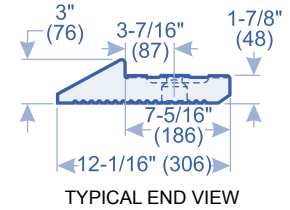
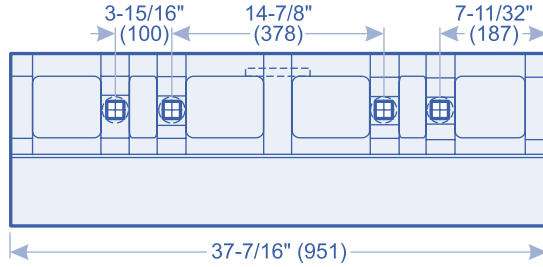
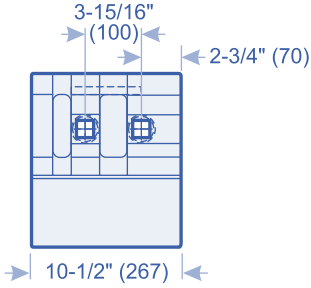
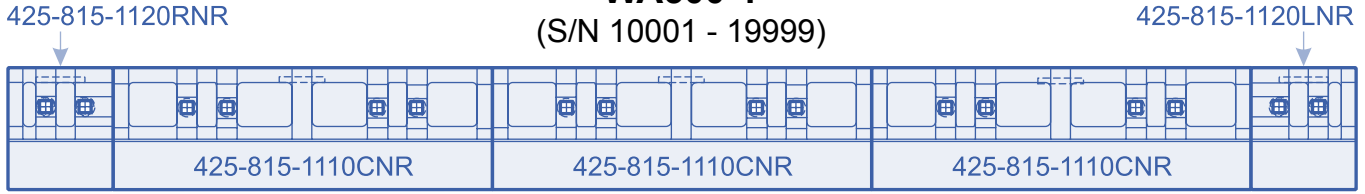

425-815-1120RNR (RH shown)
425-815-1120LNR (LH opposite)
 62.0 lbs. (28.1 kgs.) Requires (2) A10-400
 plow bolt assemblies each

425-815-1110CNR
 217.0 lbs. (98.4 kgs.)
 Requires (4) A10-400 plow bolt assemblies

WA500-1 (S/N 20001) / WA500-3

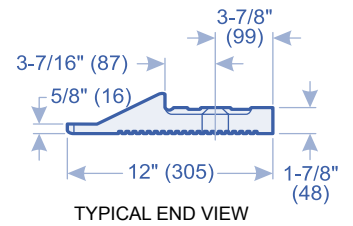
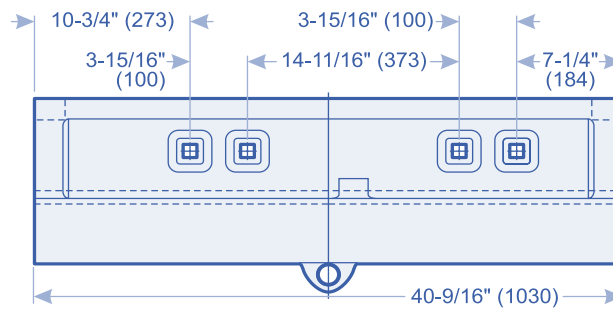
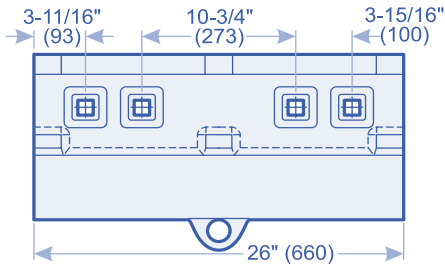
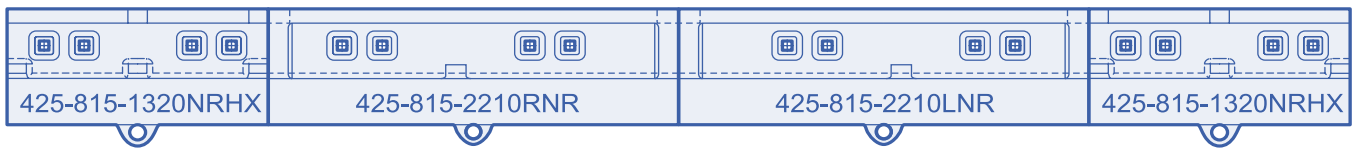

425-815-1320NRHX
 149.0 lbs. (67.6 kgs.)
 Requires (4) A10-400 plow bolt assemblies

425-815-2210RNR (RH shown)
425-815-2210LNR (LH opposite)
 222.0 lbs. (100.7 kgs.)
 Requires (4) A10-400 plow bolt assemblies

LOADERS - CONTINUED

Hensley Half Arrow Bolt-On Edges - continued

WA500-3

425-815-1520NRHX

425-815-1520NRHX

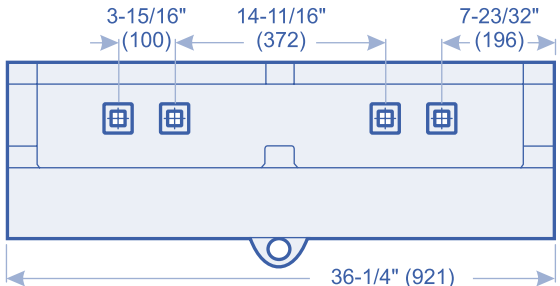

425-815-1510RLNRHX

192.0 lbs. (87.1 kgs.)

Requires (4) A10-400 plow bolt assemblies

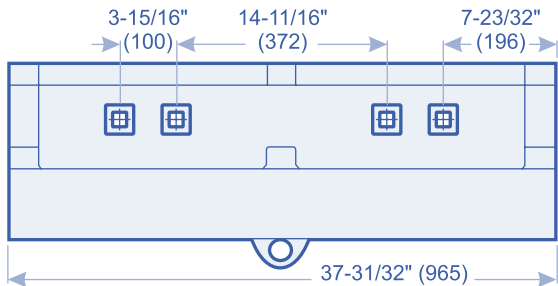

425-815-1510CNRHX

201.0 lbs. (91.2 kgs.)

Requires (4) A10-400 plow bolt assemblies

425-815-1520NRHX

61.8 lbs. (28.0 kgs.)

Requires (2) A10-400 plow bolt assemblies each

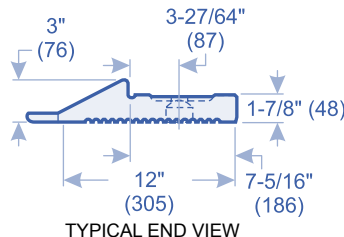
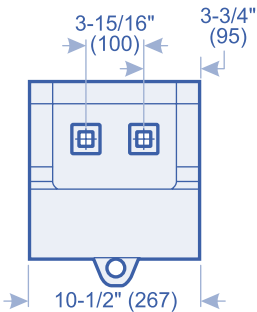

TYPICAL END VIEW

426-815-1130NRHX

WA600-1 / WA600-3

426-815-1130NRHX

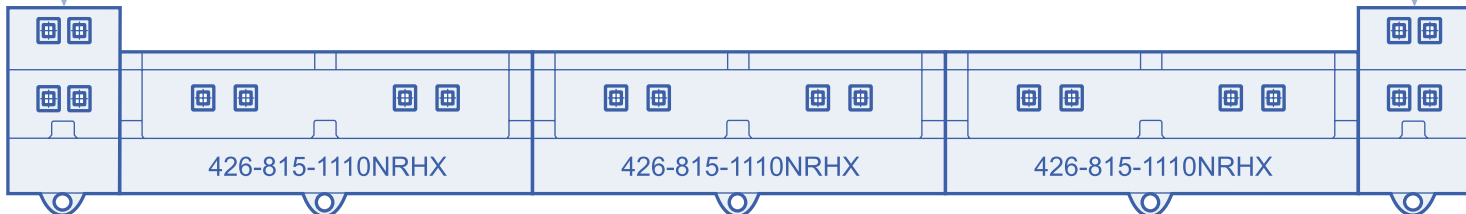

426-815-1110NRHX

236.0 lbs. (107.1 kgs.)

Requires (4) A138-400 plow bolt assemblies

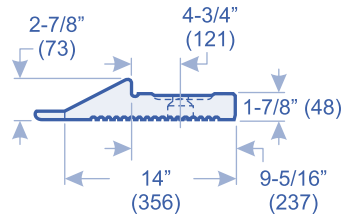
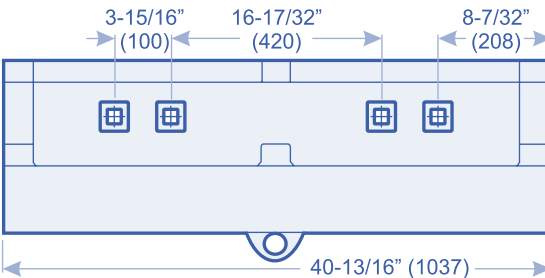

TYPICAL END VIEW

426-815-1130NRHX

85.0 lbs. (38.6 kgs.)

Requires (4) A138-400 plow bolt assemblies

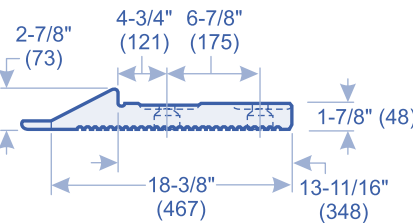
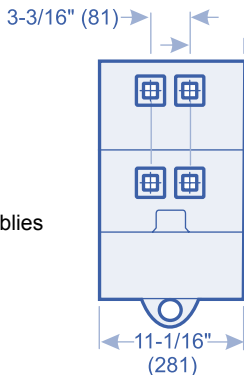

TYPICAL END VIEW

DIRECT REPLACEMENT RIPPER PRODUCTS

Tooth Pocket

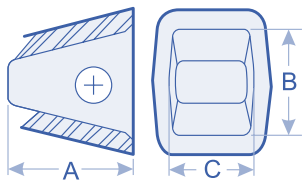

See Dimensions in Chart

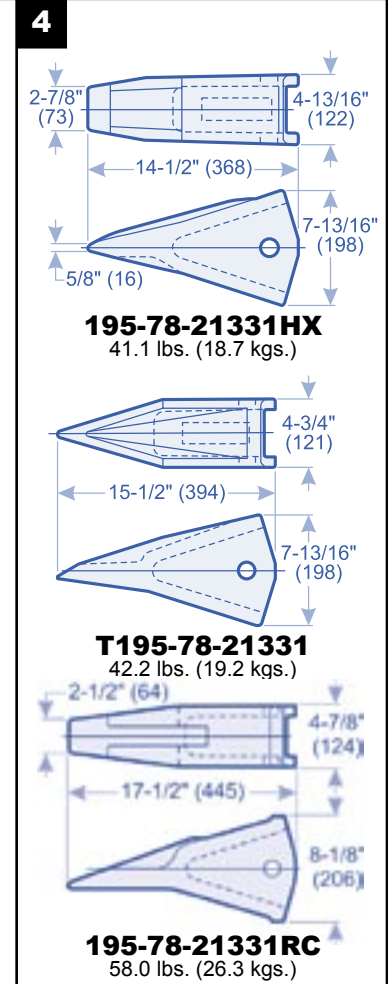
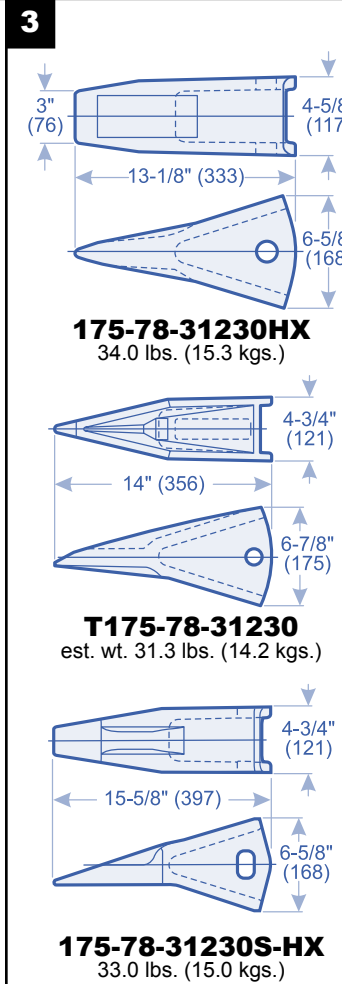
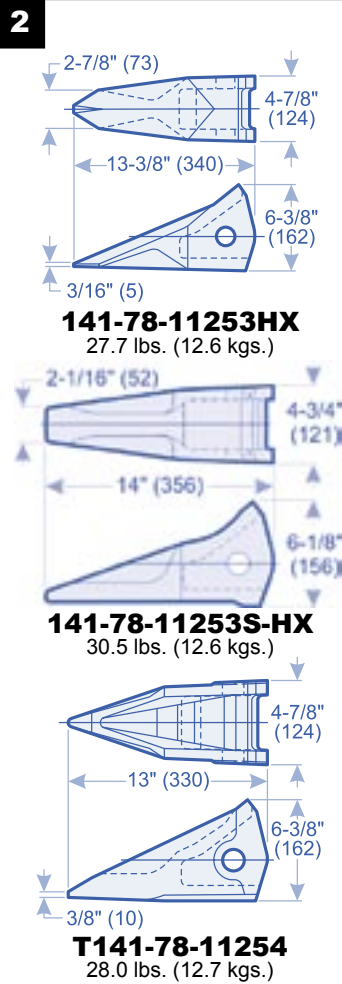
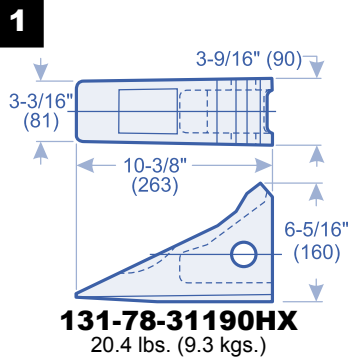

Ripper Teeth, Shank Guards, and Segments

Reference Number	Machine Model	Serial Number	Tooth	Optional Tooth	Pocket Dimensions: Inches (MM)		
					A	B	C
1	D40/D45-1, D40/D41-3 D50/D53-16, D50/D53-17 D57S-1, D66S-1	--	131-78-31190HX	--	4-7/8 (124)	4-29/32 (125)	2-5/16 (59)
2	D60/D65-7, D60/D65-8 D65-12, D75A-1 D75S-3, D75S-5 D85E-SS-2A	--	141-78-11253HX	141-78-11253S-HX T141-78-11254	5-5/8 (143)	4-29/32 (125)	3-1/16 (78)
3	D85-18 D85-21 D135A-1 D135A-2 D150A-1 D155A-1 D155A-2 D155A/AX-3	25001-35001 10001-10301-7190-7190-50001-60001	175-78-31230HX	T175-78-31230 175-78-31230S-HX	7-1/4 (184)	5-3/16 (132)	3-1/4 (83)
4	D275A-2 D355A-3	10001-1632-	195-78-21331HX	T195-78-21331 195-78-21331RC	8-5/8 (219)	6-1/16 (154)	3-5/16 (84)
5	D455A	1007-	198-79-11230HX	T198-79-11230	10-3/8 (264)	7-3/16 (183)	4-1/8 (105)
6	D375A-1	15001-15366	195-78-71140HX	--	8-3/8 (213)	6-7/16 (164)	3-1/4 (83)
7	D375A-1 D375A-2	15367-16001-	195-78-71320HX	195-78-71350HX	8-15/32 (215)	6-1/16 (154)	3-1/4 (83)
8	D475A-1, D475A-2	--	198-78-21340HX	198-78-21370HX	10-13/32 (264)	7-9/32 (185)	4-1/8 (105)
9	D575A	--	T19M-78-11341	--	7-3/4 (197)	7-9/32 (185)	5 (127)
10	GD825A-2	--	235-785-1310HX	--	--	--	--
11	Dresser TD25	--	1313564H1HX	--	7-3/4 (197)	5-3/8 (136)	3 (76)

FOR KOMATSU DOZERS & MOTOR GRADERS

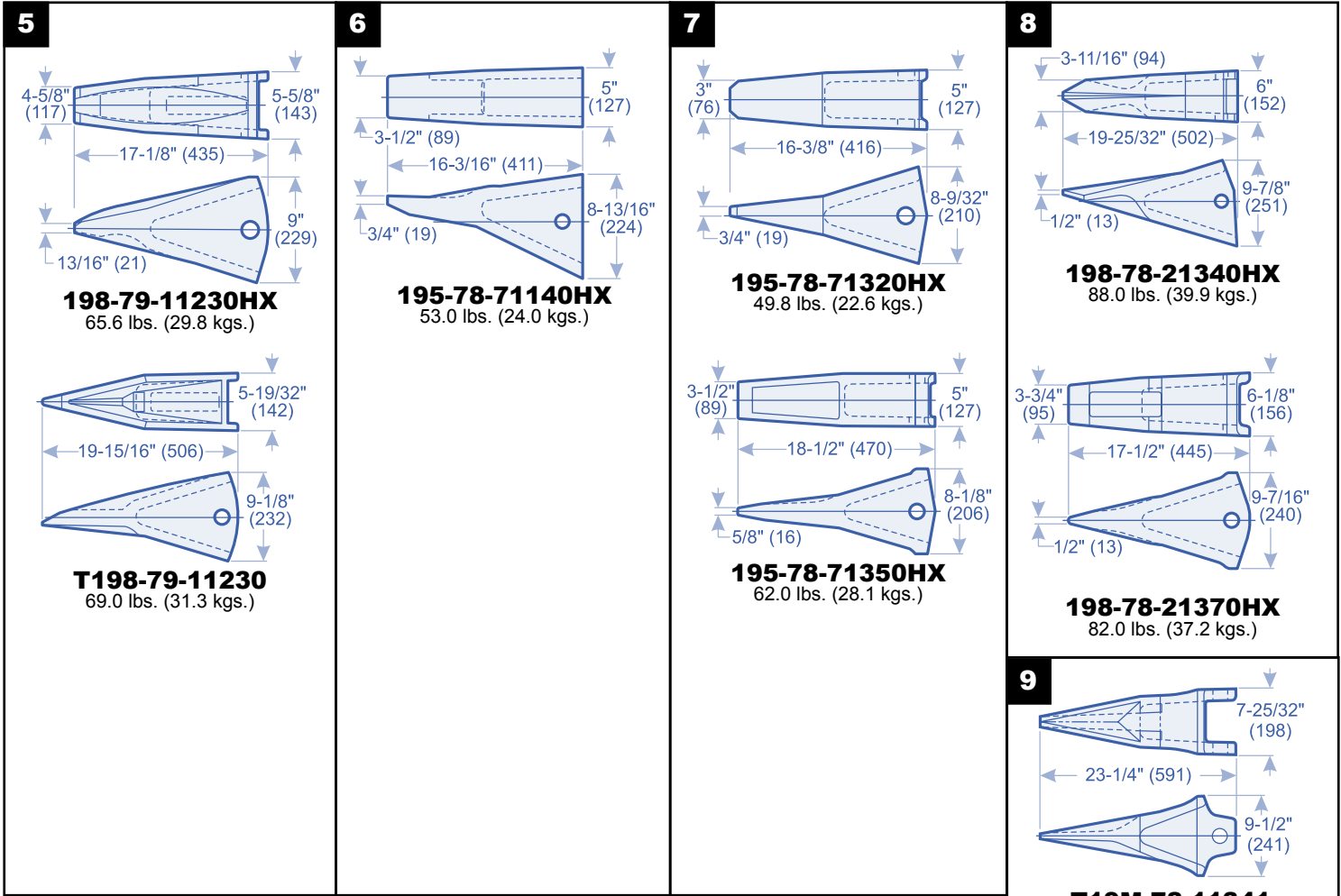

10 Motor Grader Tooth

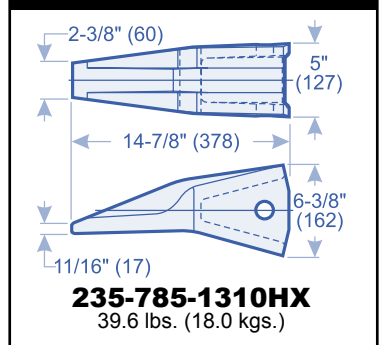

11 Dresser Dozer

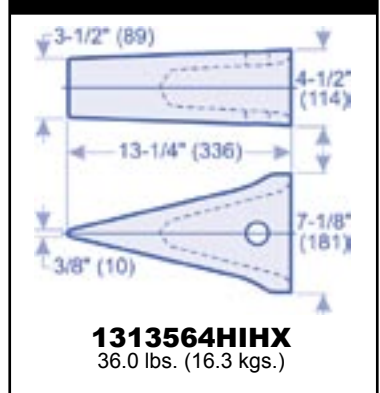

	Tooth Pin	Lower Segment	Shank Guard	Optional Guard	Guard Pin
	092-44-02496P	--	--	--	--
	175-78-21740P	--	--	--	--
	175-78-21740P	175-78-21693MHX (under development)	195-78-21320HX	195-78-21580HX	175-78-21740P
	175-78-21740P	17M-78-1340HC* 17M-78-21360HX	195-78-21320HX	195-78-21580HX	175-78-21740P
	426-847-2310P	--	--	--	--
	175-78-21740P	--	195-78-71110HX	--	175-78-21740P
	195-78-71360P	195-78-71380HX	195-78-72410HX	--	092-44-03036P
	198-78-21340PL	198-78-21430HX	198-78-21330HX	198-78-21390HX	198-78-21340PL
	--	--	--	--	--
	--	--	--	--	--
	092-44-02488P	--	--	--	--

*under development

DIRECT REPLACEMENT RIPPER PRODUCTS - CONTINUED

Weld-on Segments

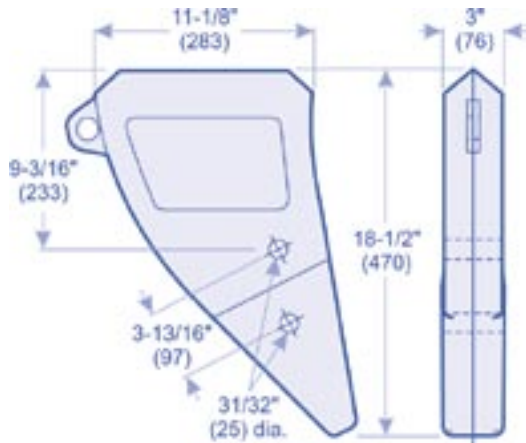

17M-78-21360HX
112.0 lbs. (50.8 kgs.)

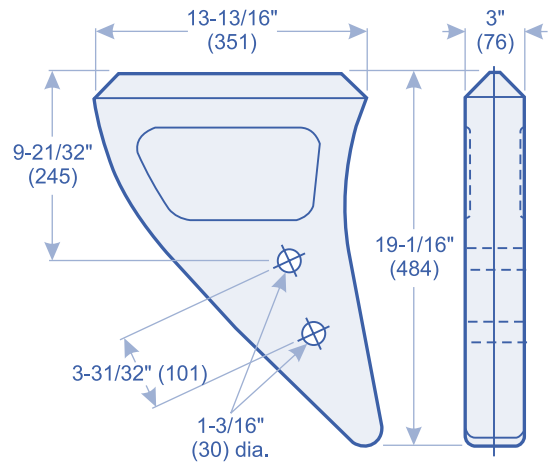

195-78-71380HX
126.0 lbs. (57.1 kgs.)

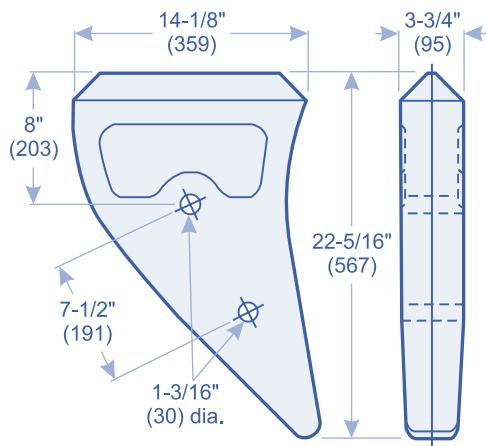

198-78-21430HX
198.0 lbs. (89.8 kgs.)

Shank Guards

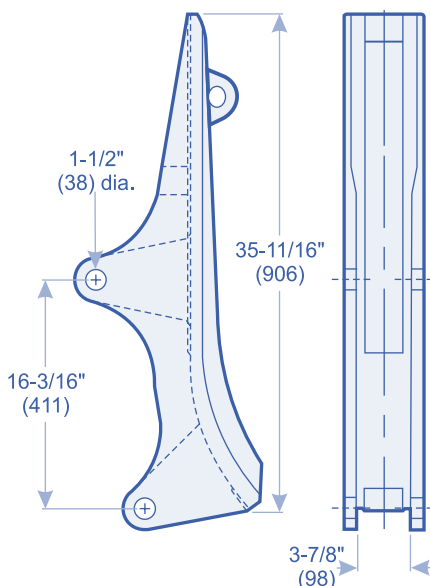

198-78-21390HX
148.0 lbs. (67.1 kgs.)

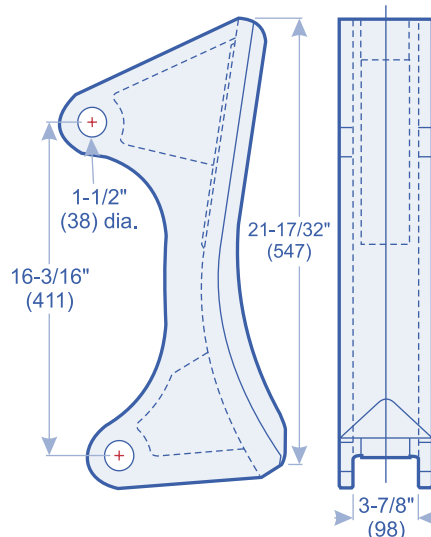

198-78-21330HX
86.0 lbs. (39.0 kgs.)

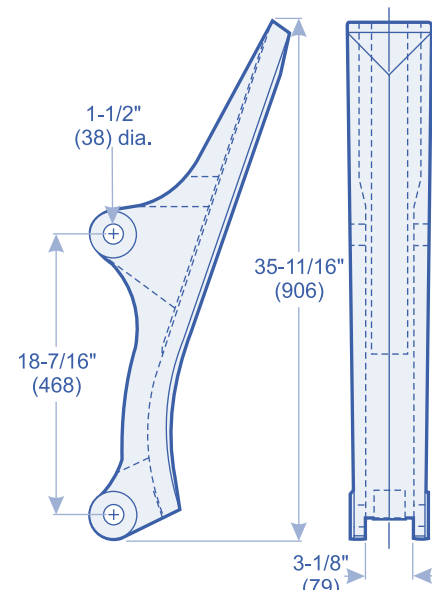

195-78-72410HX
111.0 lbs. (49.9 kgs.)

DIRECT REPLACEMENT RIPPER PRODUCTS - CONTINUED

Shank Guards - continued

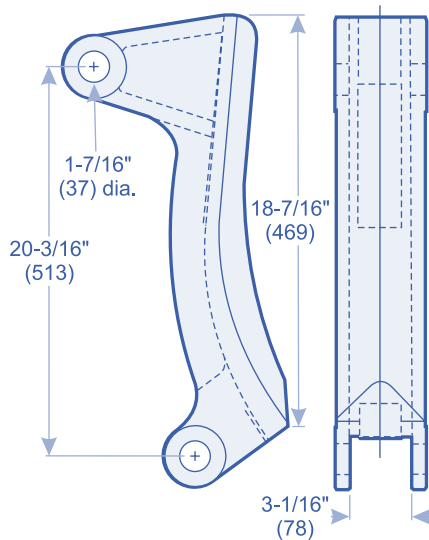

195-78-71110HX
54.0 lbs. (24.5 kgs.)

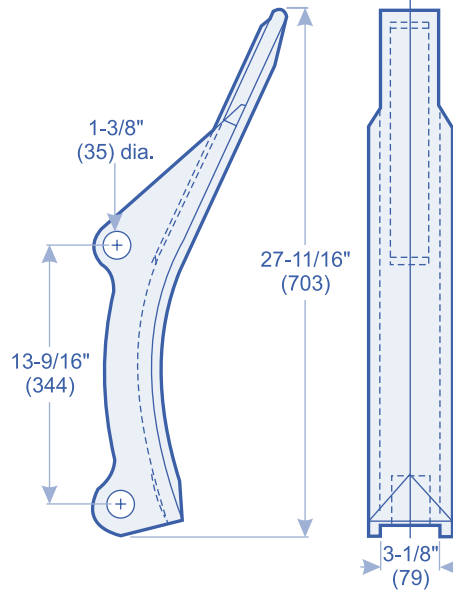

195-78-21580HX
51.7 lbs. (23.5 kgs.)

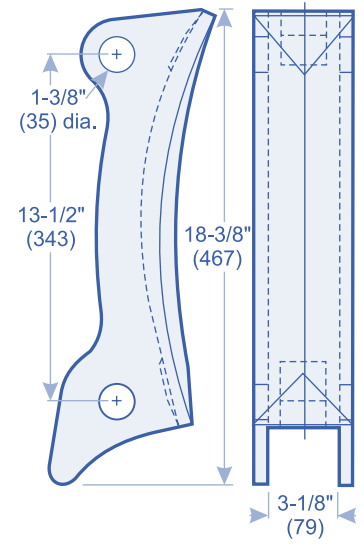

195-78-21320HX
33.6 lbs. (15.3 kgs.)

Ripper Replacement Pins

Dimensions: Inches (MM)

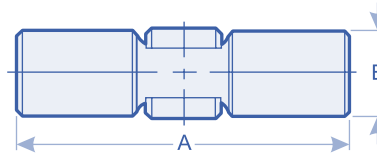

Pin Part Number	Dimensions: Inches (MM)	
	A	B
092-44-02496P	3-25/32 (96)	31/32 (25) dia.
175-78-21740P	4-5/8 (117)	31/32 (25) dia.
426-847-2310P	5-21/32 (143)	1-5/32 (29) dia.
198-78-21340PL	6 (152)	1-3/16 (30) dia.

REPLACEMENT PARTS FOR KOMATSU DOZERS

End Bits

140-70-11180HX (RH shown)
140-70-11170HX (LH opposite)

35.8 lbs. (16.2 kgs.)

Requires (5) A34-400 plow bolt assemblies each

Fits: D50A, D53A
D60, D65
model dozers.

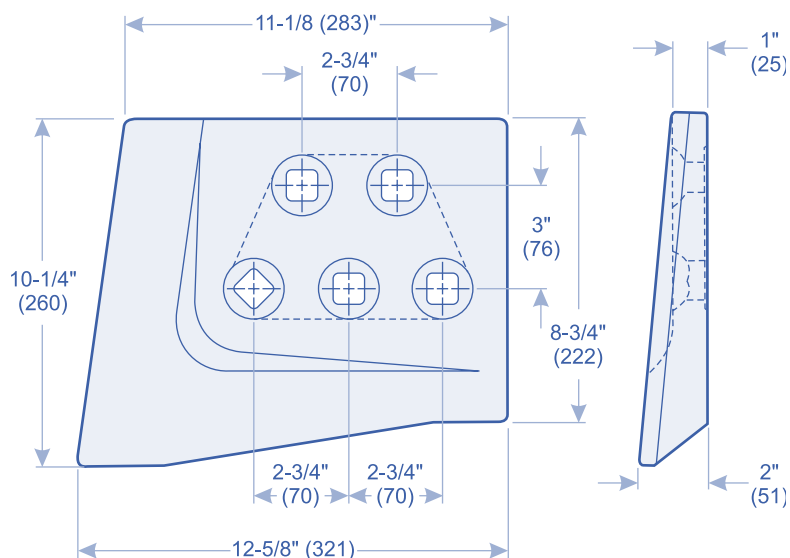

195-71-61940RH (RH shown)
195-71-61930LH (LH opposite)

260.0 lbs. (118.0 kgs.)

Fits: D375A-1
D375A-2
D375A-3
model dozers.

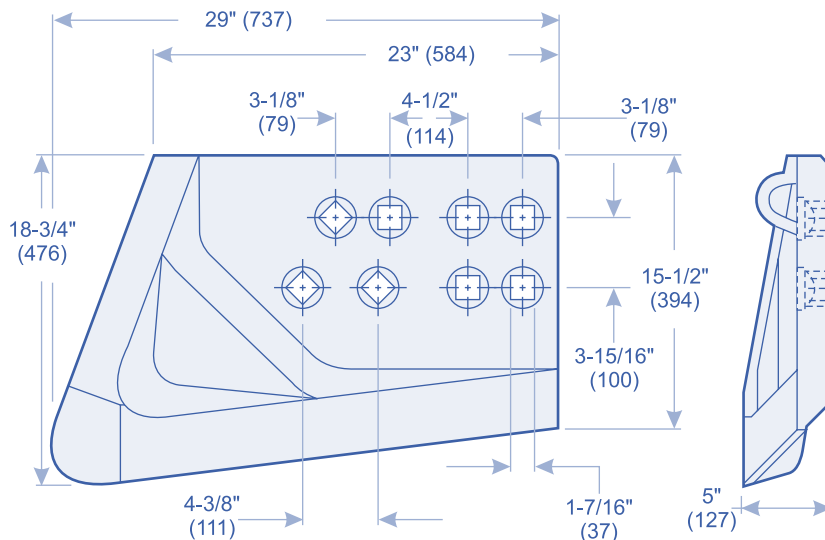

198-71-31530HX (RH shown)
198-71-31520HX (LH opposite)

317.0 lbs. (143.8 kgs.)

Plow-bolts not available
 from Hensley Industries.

Fits: D475A-1
D475A-2
model dozers.

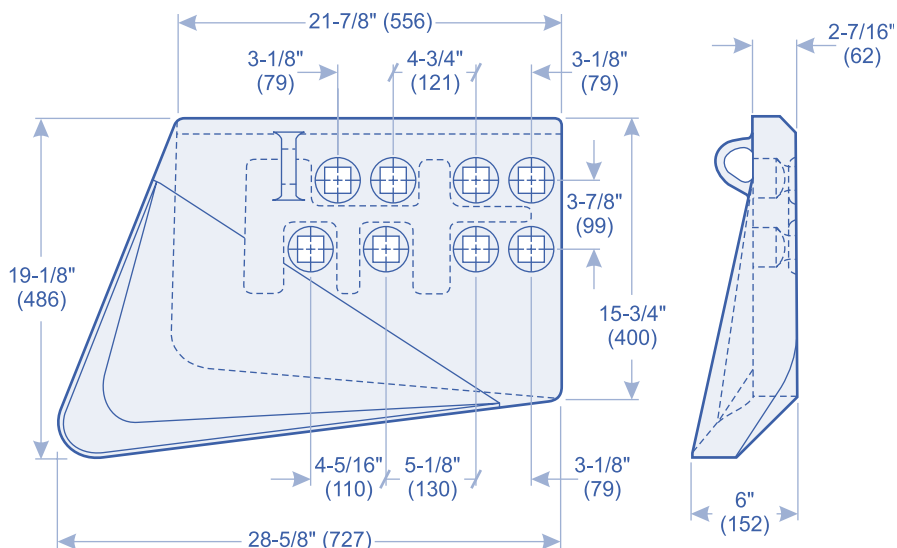

REPLACEMENT PARTS FOR KOMATSU DOZERS

End Bits - continued

19M-72-13220HX (RH shown)
19M-72-13210HX (LH opposite)
 472.0 lbs. (214.0 kgs.)
 Plow-bolts not available
 from Hensley Industries.

**Fits: D575A-2
 model dozers.**

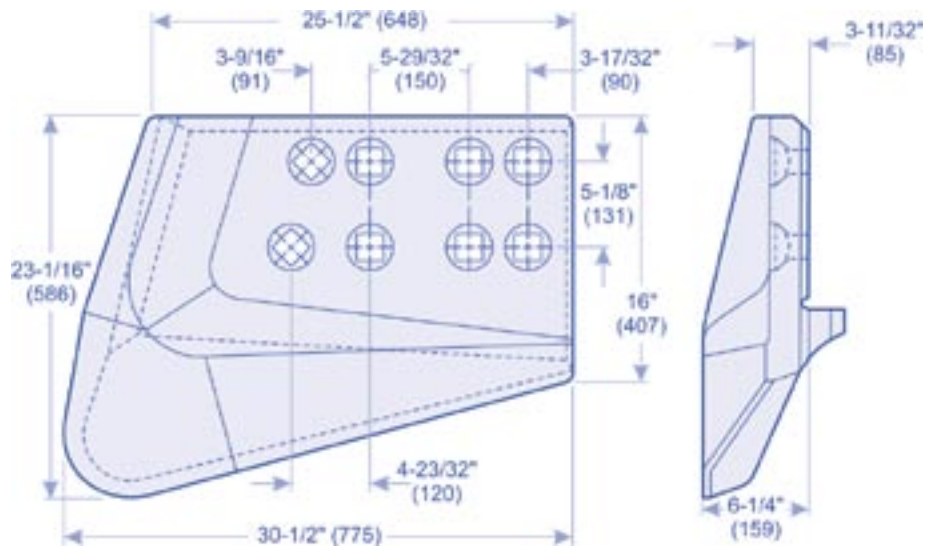

Part Replacement Note:

19M-72-21710 uses 19M-72-13210HX
 19M-72-21720 uses 19M-72-13220HX

PLOW BOLT ASSEMBLIES

Hensley plow bolt assembly numbers designate the diameter and length of the bolt.

example: **A10-312**

First number indicates
 bolt diameter which in
 this case is 1".

Second number indicates
 bolt length which in this
 case is 3-1/2".

PLOW BOLT ASSEMBLIES*		DIMENSIONS	
w/Hex Nut	w/Hex Cone Nut	Diameter w/ Threads per Inch	Bolt Length
A34-200		3/4"	10
A34-300		3/4"	10
A78-300		7/8"	9
A78-314		7/8"	9
A78-400		7/8"	9
A10-200	AC10-200	1"	8
A10-312	AC10-312	1"	8
A10-334	AC10-334	1"	8
A10-400	AC10-400	1"	8
A10-412	AC10-412	1"	8
A114-300	AC114-300	1-1/4"	7

*Plow Bolt Assemblies consists of Plow Bolt with Nut.

NOTES

NOTES

NOTES

SAFETY FIRST: Hensley recommends that you use a soft-faced hammer **and** ANSI-approved (Z87.1) eye protection while using our products.

Hensley Industries, Inc.

2108 Joe Field Rd. • Dallas, TX 75229

Customer Service Toll Free U.S. / Canada

Phone: (888) 406 - 6262

Fax: (888) 241 - 3274

All Other Locations

Phone: (972) 406 - 6262

Fax: (972) 241 - 3274



www.hensleyind.com

Your Authorized Hensley Dealer