



CONSTRUCTION

Road Rehabilitation • Road King™





BUZZLE the ROAD

Be in complete command of your road rehabilitation needs with our Road King™ tool series — combining superior holder protection and easy penetration to drive maximum machine performance.



kennametal.com

Road King™

Road Rehabilitation Conicals for Cutting

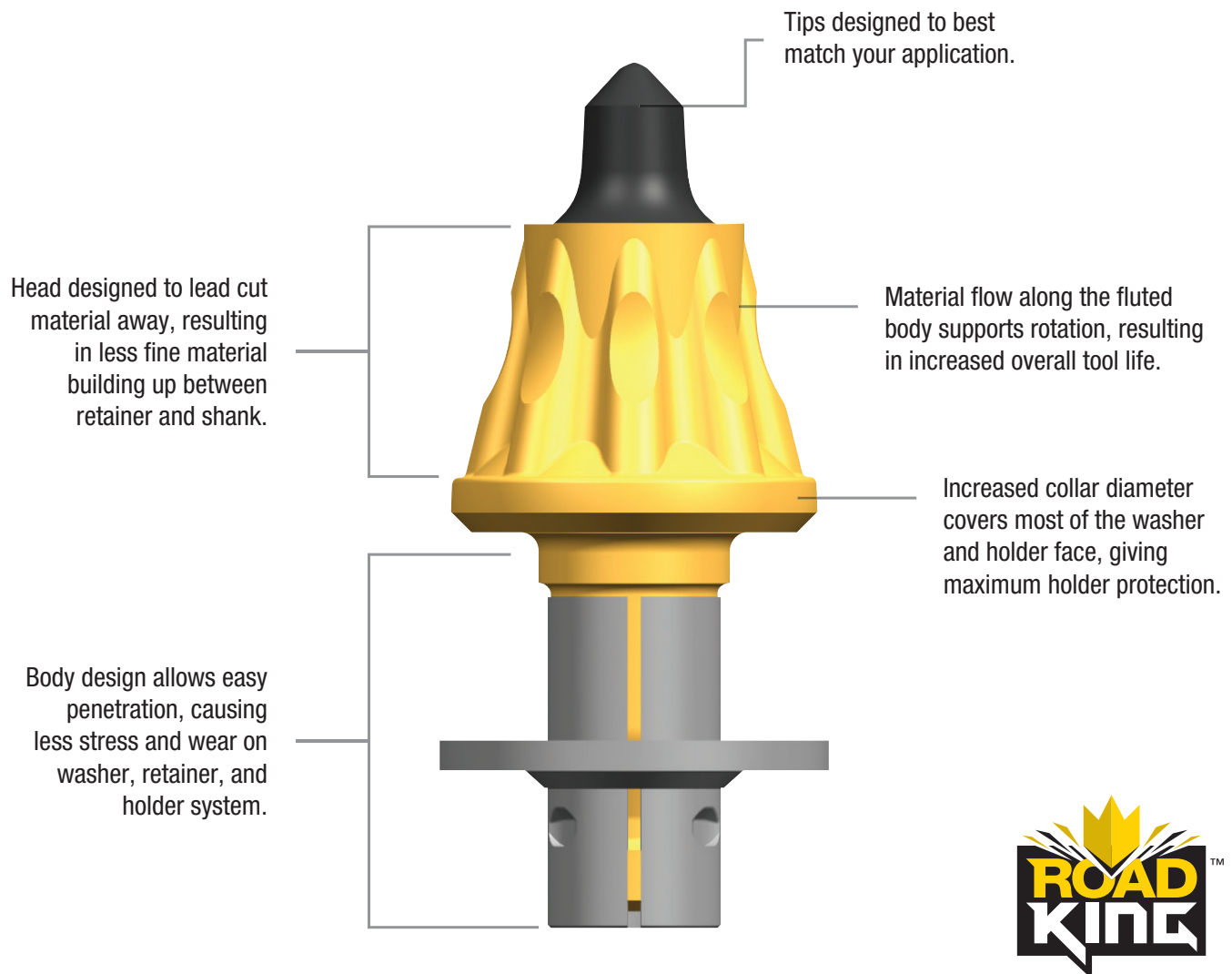

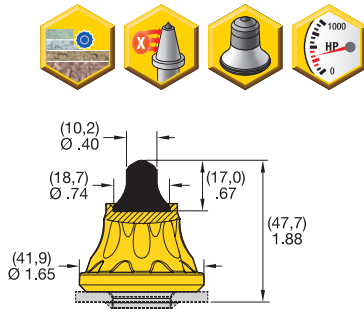

Road King™ • RK3-01

order number	catalog number
6080814	RK3-01

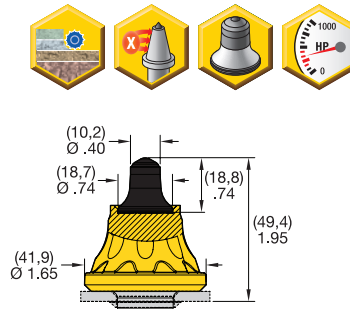

Road King • RK3-02

order number	catalog number
6080817	RK3-02

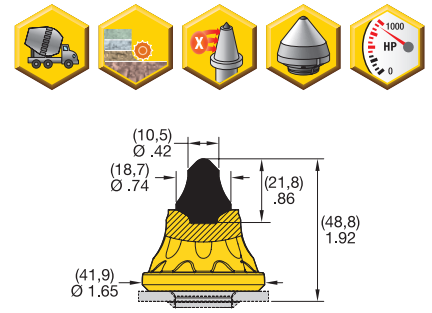

Road King • RK3-03

order number	catalog number
6080820	RK3-03

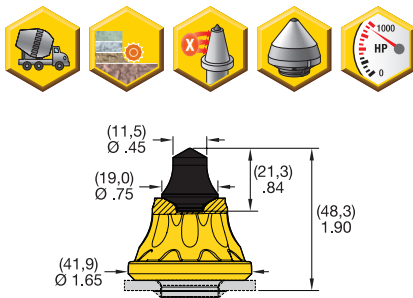

Road King™ • RK4-01

order number	catalog number
6080818	RK4-01

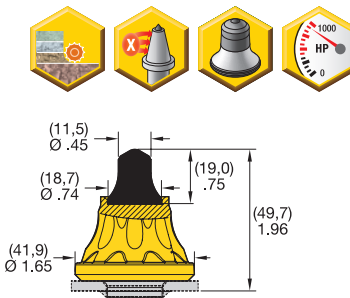

Road King • RK4-03

order number	catalog number
6080816	RK4-03

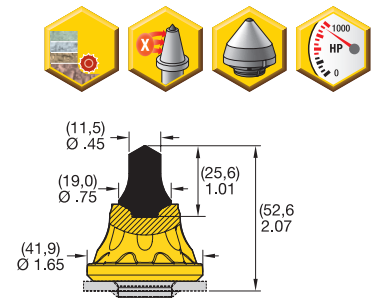

Road King • RK5-01

order number	catalog number
6080819	RK5-01

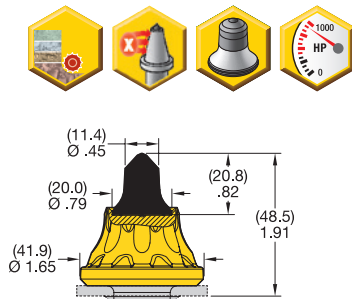

Road King™ • RK5-04

order number	catalog number
6227535	RK5-04

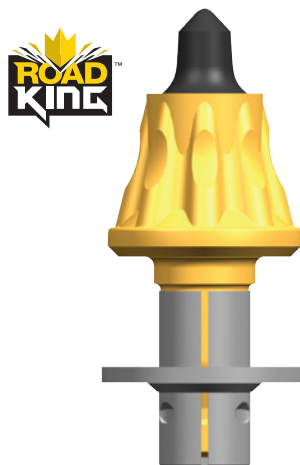

Packaging Information

order number	catalog number	container type	pieces per container	container weight (approximate)		containers per pallet	pieces per pallet	pallet weight (approximate)	
				kg	lbs			kg	lbs
6080814	RK3-01	box	50	15	33	60	3000	900	1980
6080817	RK3-02	box	50	15,5	34	60	3000	930	2040
6080820	RK3-03	box	50	16	35,5	60	3000	960	2130
6080818	RK4-01	box	50	16,5	36,5	60	3000	990	2190
6080816	RK4-03	box	50	16	35,5	60	3000	960	2130
6080819	RK5-01	box	50	17	37,5	60	3000	1020	2250
6227535	RK5-04	box	50	16	35,5	60	3000	960	2130

Dimensions shown in (millimeters) and inches.

Road King™

Road Rehabilitation Conicals with Puller Groove for Cutting

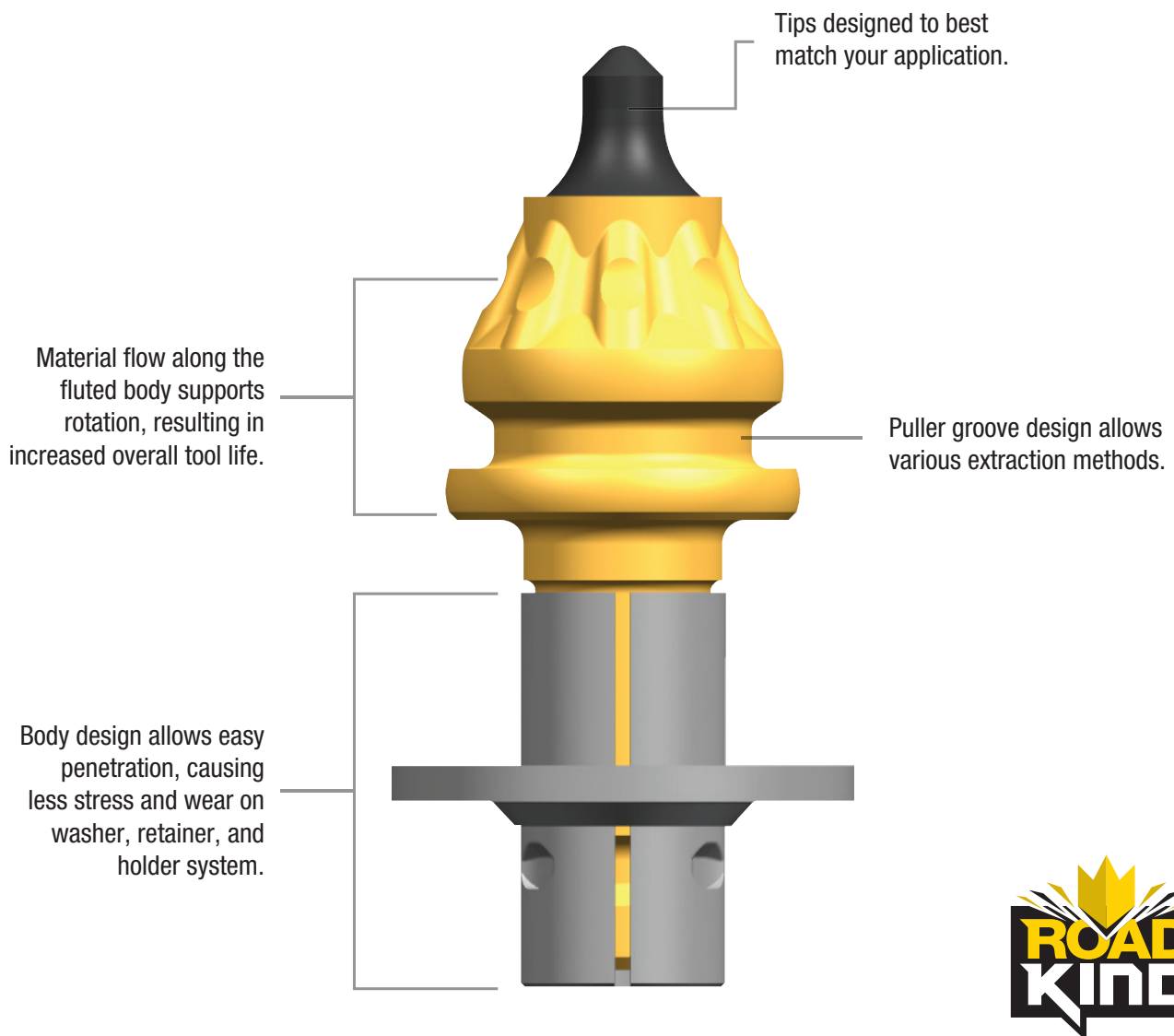

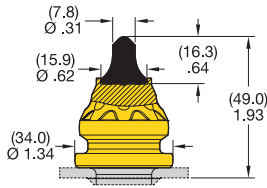

Road King™ • RK1-01P

order number	catalog number
6299498	RK1-01P

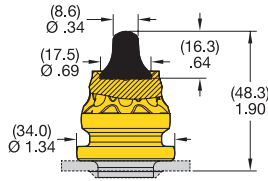

Road King • RK2-01P

order number	catalog number
6299499	RK2-01P

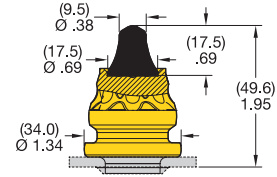

Road King • RK2-02P

order number	catalog number
6299500	RK2-02P

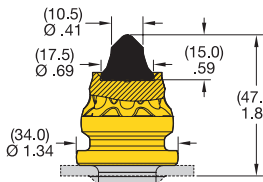

Road King™ • RK2-03P

order number	catalog number
6299541	RK2-03P

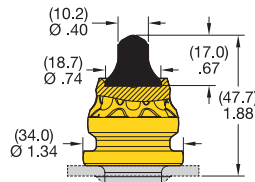

Road King • RK3-01P

order number	catalog number
6299542	RK3-01P

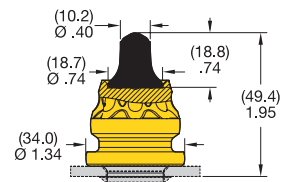

Road King • RK3-02P

order number	catalog number
6299543	RK3-02P

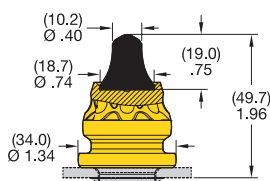

Road King™ • RK4-02P

order number	catalog number
6299544	RK4-02P

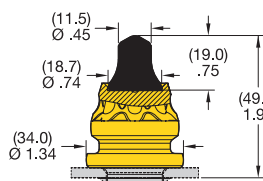

Road King • RK4-03P

order number	catalog number
6299545	RK4-03P

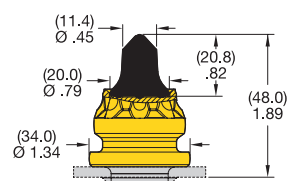

Road King • RK5-04P

order number	catalog number
6299548	RK5-04P

Packaging Information

order number	catalog number	container type	pieces per container	container weight (approximate)		containers per pallet	pieces per pallet	pallet weight (approximate)	
				kg	lbs			kg	lbs
6299498	RK1-01P	box	50	15,9	35.1	60	3000	954	2104
6299499	RK2-01P	box	50	15,9	35.1	60	3000	954	2104
6299500	RK2-02P	box	50	16,1	35.5	60	3000	966	2130
6299541	RK2-03P	box	50	16,1	35.5	60	3000	966	2130
6299542	RK3-01P	box	50	16,3	35.8	60	3000	975	2150
6299543	RK3-02P	box	50	16,4	36.1	60	3000	981	2163
6299544	RK4-02P	box	50	16,6	36.5	60	3000	993	2190
6299545	RK4-03P	box	50	16,6	36.5	60	3000	993	2190
6299548	RK5-04P	box	50	16,8	37.0	60	3000	1008	2223

Dimensions shown in (millimeters) and inches.

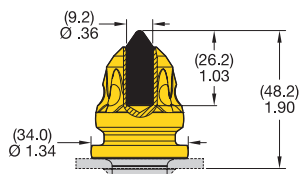

Road King™ • RK1-PT

order number	catalog number
6299546	RK1-PT

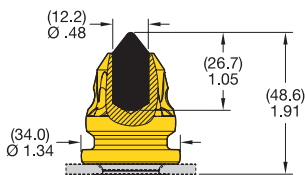

Road King • RK3-PT

order number	catalog number
6299547	RK3-PT



Packaging Information

order number	catalog number	container type	pieces per container	container weight (approximate)		containers per pallet	pieces per pallet	pallet weight (approximate)	
				kg	lbs			kg	lbs
6299546	RK1-PT	box	50	15,9	35.1	60	3000	954	2104
6299547	RK3-PT	box	50	16,4	36.1	60	3000	981	2163

Dimensions shown in (millimeters) and inches.



KenCast™

Road Rehabilitation takes your tooling equipment through rough conditions

KenCast parts are unique because no one makes wear parts like Kennametal. These extremely durable wear-resistant parts are manufactured in our own foundry.

Your equipment runs in abrasive conditions. Protect your investment with Kennametal KenCast composite material. It combines the exceptional wear resistance of Kennametal cemented tungsten carbide with the toughness and practicality of air-hardened steel.

Use KenCast parts on:

Reclamation Equipment

- Pedestal protectors
- Side cleaner bars

Road Planing Equipment

- Kicker plates
- Drag shoes
- Quick-change block-base protectors

Trenching Equipment

- Base segment protection

KenCast Parts Are:

- Easier to apply and tougher than brazed-on solid carbide tiles.
- Longer lasting and easier to apply than hardfacing material.
- More wear resistant than standard or AR-type steels.
- Better at protecting the carbide particles than embedded weld overlays.

Stabilizer King

Road Rehabilitation Conicals for Cutting/Stabilizing

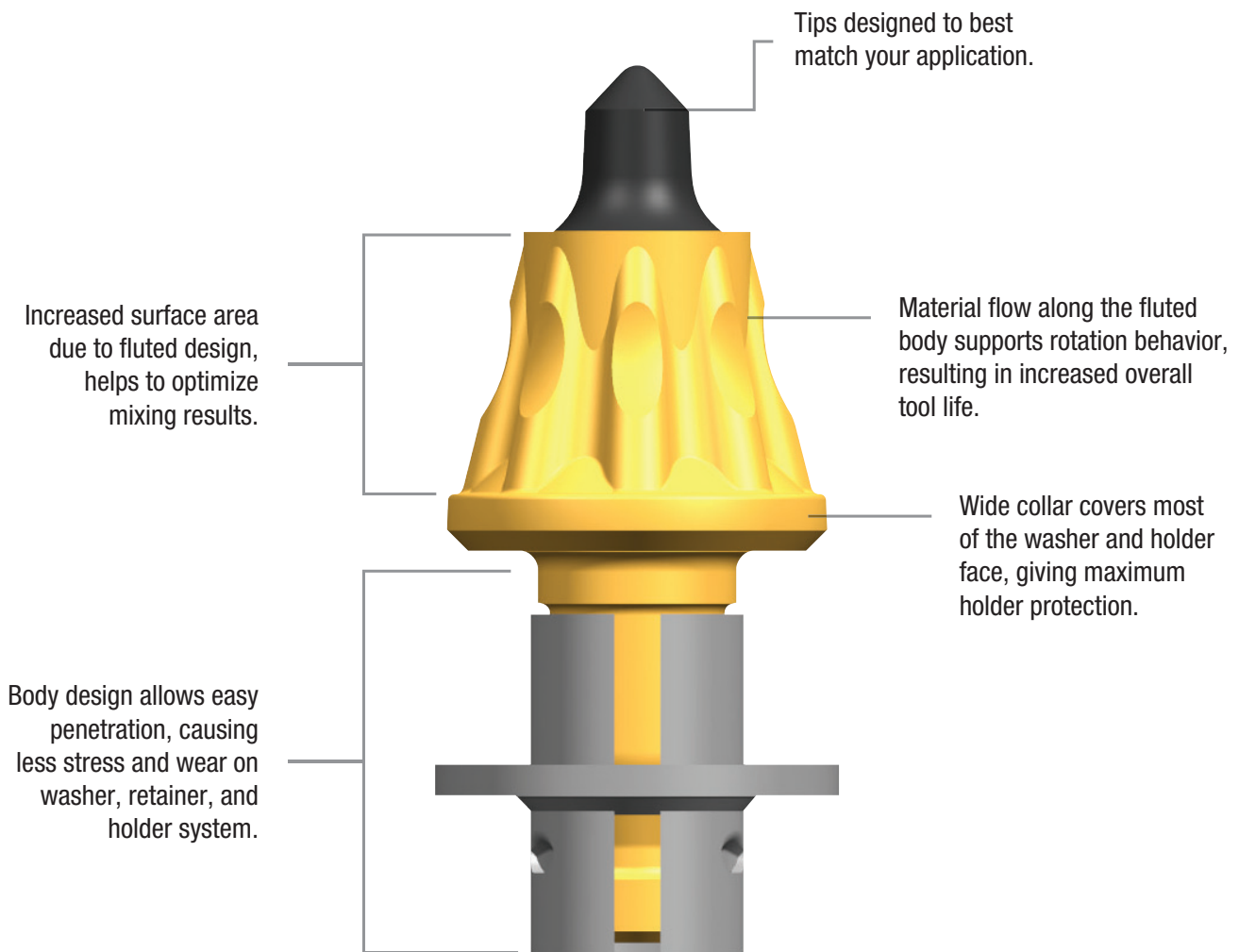

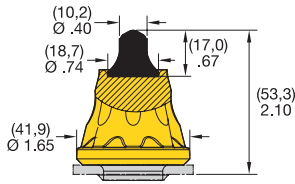

■ Stabilizer King • SK3-01

order number	catalog number
6080871	SK3-01

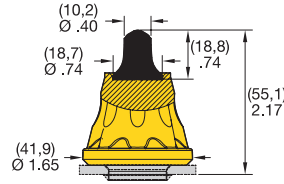

■ Stabilizer King • SK3-02

order number	catalog number
6080874	SK3-02

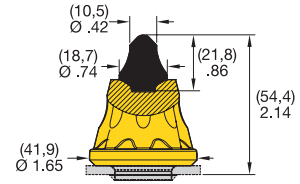

■ Stabilizer King • SK3-03

order number	catalog number
6080878	SK3-03

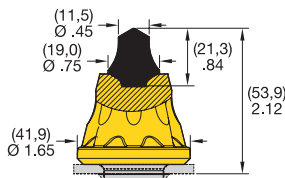

■ Stabilizer King • SK4-01

order number	catalog number
6080876	SK4-01

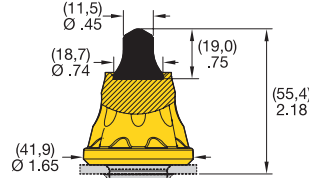

■ Stabilizer King • SK4-03

order number	catalog number
6080875	SK4-03

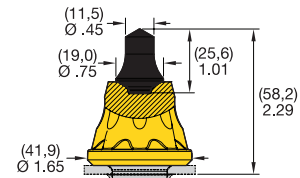

■ Stabilizer King • SK5-01

order number	catalog number
6080877	SK5-01

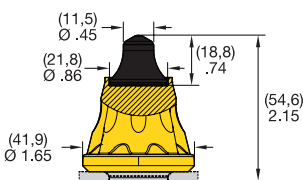

■ Stabilizer King • SK5-02

order number	catalog number
6080873	SK5-02

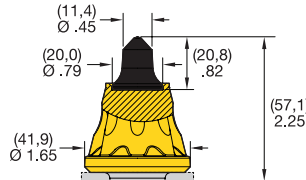

■ Stabilizer King • SK5-03

order number	catalog number
6080872	SK5-03



■ Packaging Information

order number	catalog number	container type	pieces per container	container weight (approximate)		containers per pallet	pieces per pallet	pallet weight (approximate)	
				kg	lbs			kg	lbs
6080871	SK3-01	box	40	15,6	34,4	60	2400	936	2064
6080874	SK3-02	box	40	15,6	34,8	60	2400	936	2088
6080878	SK3-03	box	40	16	35,2	60	2400	960	2112
6080876	SK4-01	box	40	16,4	35,6	60	2400	984	2136
6080875	SK4-03	box	40	16	35,2	60	2400	960	2112
6080877	SK5-01	box	40	16,4	35,6	60	2400	984	2136
6080873	SK5-02	box	40	16,4	36	60	2400	984	2160
6080872	SK5-03	box	40	16	35,2	60	2400	960	2112

Dimensions shown in (millimeters) and inches.

Attachment King

Road Rehabilitation Conicals for Cutting

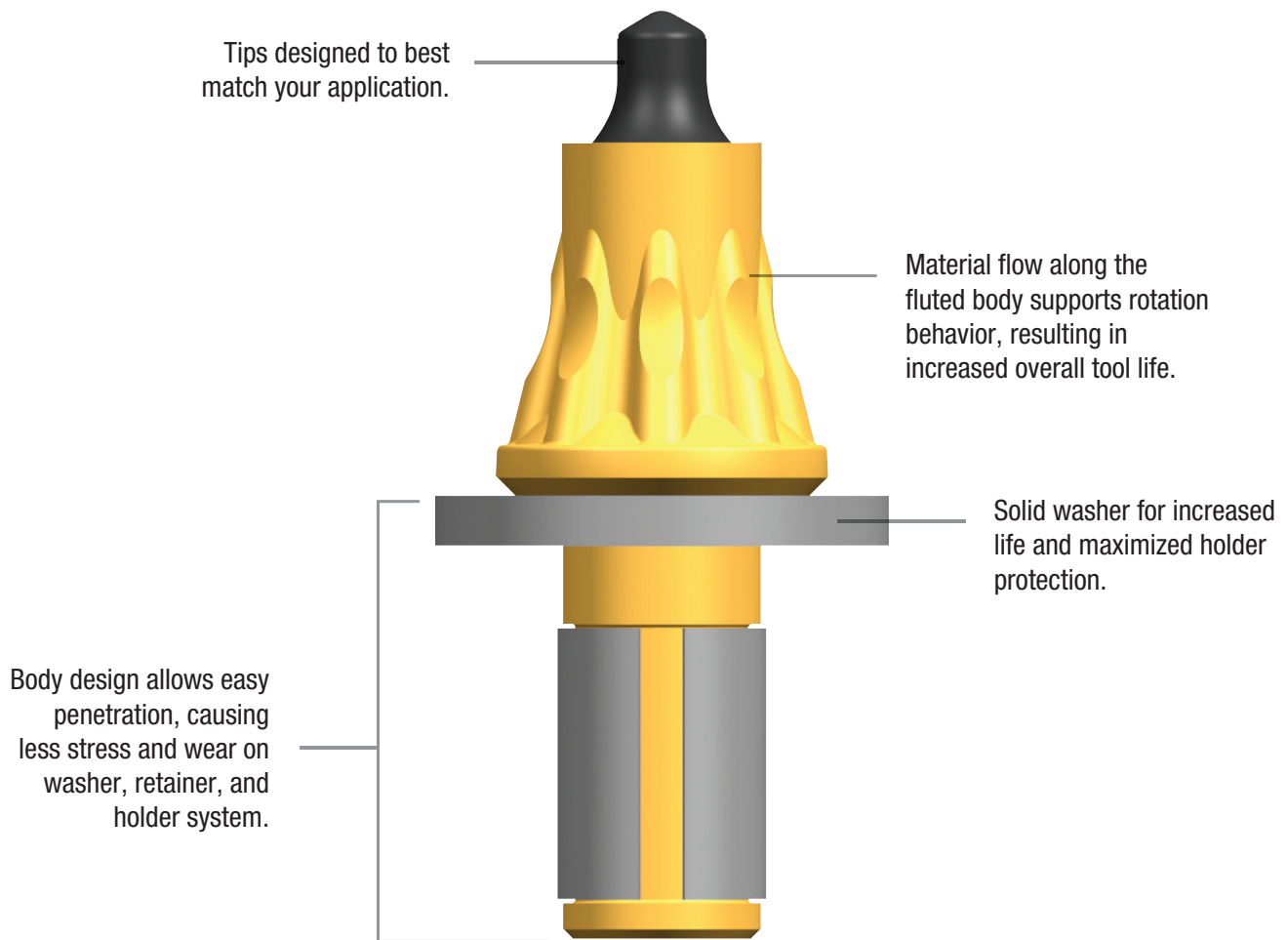

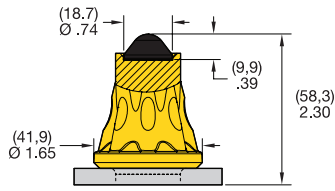

Attachment King • AK2-01

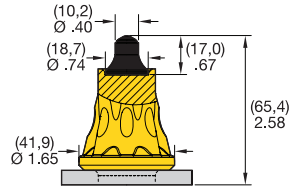
order number	catalog number
6080879	AK2-01

Attachment King • AK3-01

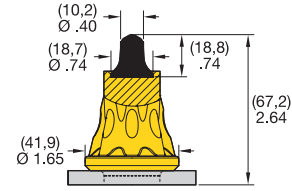
order number	catalog number
6080891	AK3-01

Attachment King • AK3-02

order number	catalog number
6080880	AK3-02

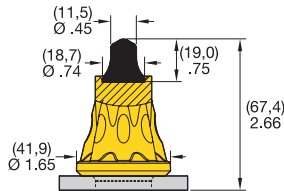
Attachment King • AK4-03

order number	catalog number
6080892	AK4-03



Packaging Information

order number	catalog number	container type	pieces per container	container weight (approximate)		containers per pallet	pieces per pallet	pallet weight (approximate)	
				kg	lbs			kg	lbs
6080879	AK2-01	box	25	14,5	32	60	1500	870	1920
6080891	AK3-01	box	25	14,75	32.3	60	1500	885	1935
6080880	AK3-02	box	25	14,5	32	60	1500	870	1920
6080892	AK4-03	box	25	14,75	32.3	60	1500	885	1935

Dimensions shown in (millimeters) and inches.

Road Rehabilitation Icons

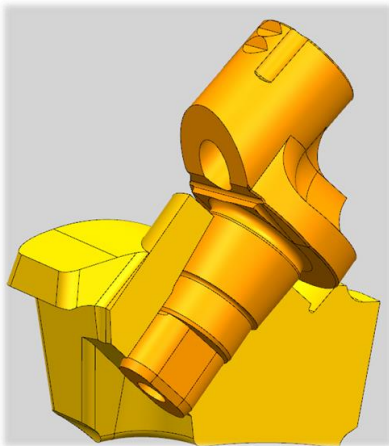
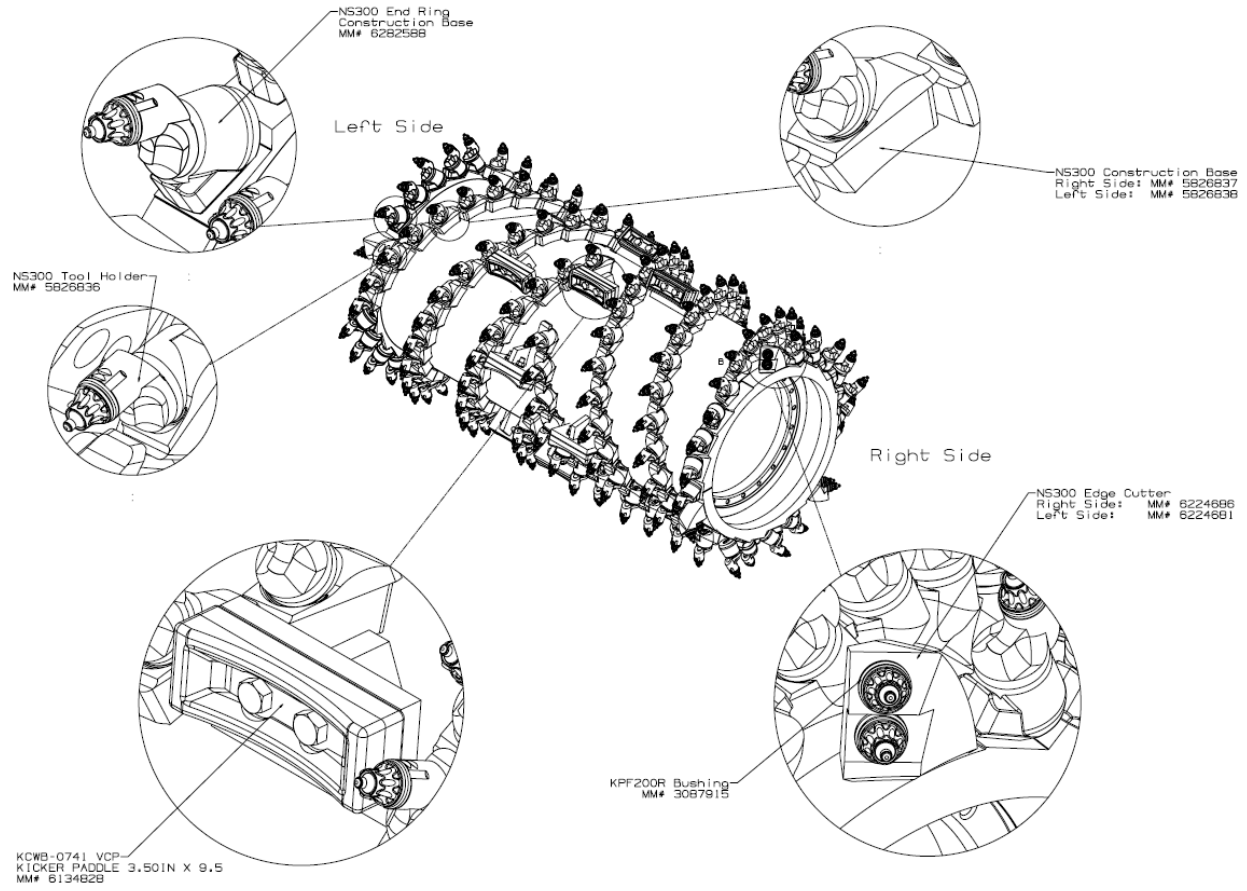
 <p>Pressed Contact</p>	 <p>Cutting Conditions: Abrasive</p>	 <p>Cutting Conditions: Concrete</p>
 <p>Cutting Conditions: Light</p>	 <p>Cutting Conditions: Medium</p>	 <p>Cutting Conditions: Heavy</p>
 <p>Cutting Conditions: Severe</p>	 <p>Noise Reduction</p>	 <p>X Treatment</p>
 <p>Insert Type: Plug</p>	 <p>Insert Type: Valve Seat</p>	 <p>Insert Type: Cap</p>
 <p>Fuel Efficiency</p>	 <p>Low Horsepower: <100HP</p>	 <p>Medium Horsepower: 100-300HP</p>
 <p>High Horsepower: 300-1000HP</p>	 <p>Tool with Puller Groove</p>	



order number	catalog number
5826837	NS300 Base Right Side
5826838	NS300 Base Left Side
6224686	NS300 Edge Cutter Right Side
6224681	NS300 Edge Cutter Left Side
6282588	NS300 End Ring Base
5826836	NS300 Tool Holder
6134828	KCWB-0741-VCP
3087915	KPF200R Sleeve

Toolholder Systems

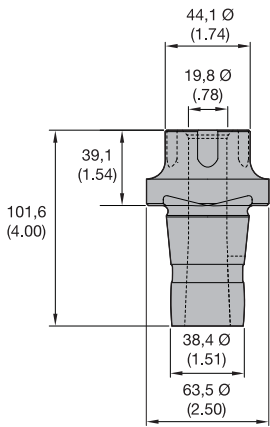

■ KPF303R Sleeve

order number	catalog number
3545505	KPF303R

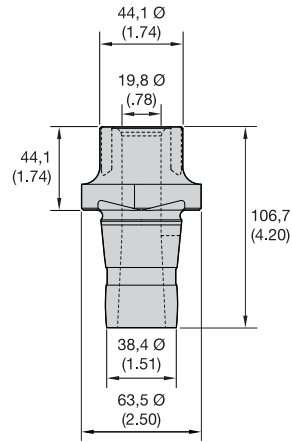

■ KPF303RX Sleeve

order number	catalog number
3843791	KPF303RX

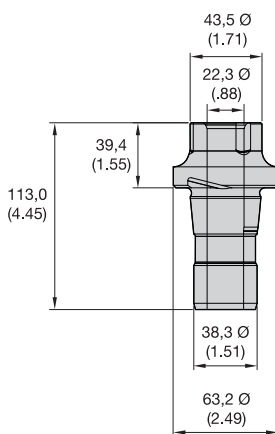

■ KPF303-87 Sleeve

order number	catalog number
2497314	KPF303-87 SLEEVE

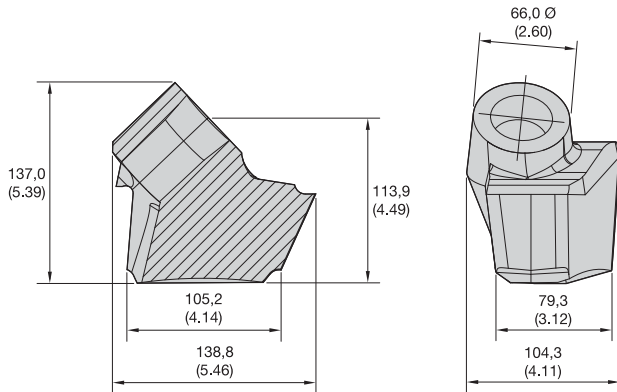
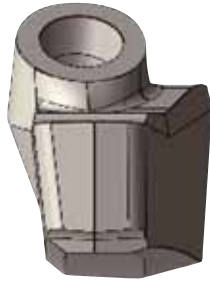

■ KPL302 Base • Left Hand

order number	catalog number
5328733	KPL302 BASE

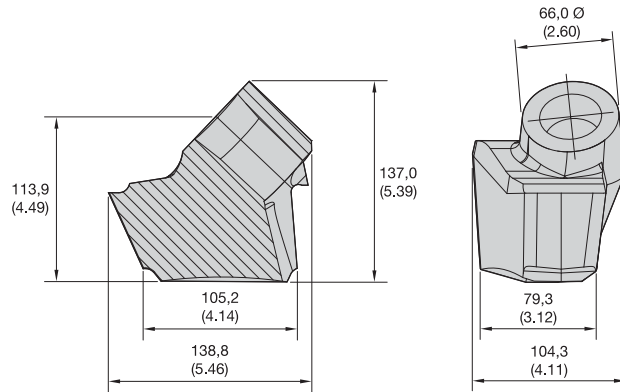

■ KPR302 Base • Right Hand

order number	catalog number
5328732	KPR302 BASE

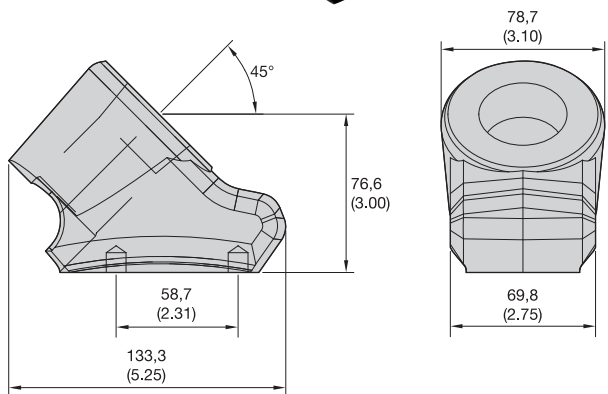

■ KPF301 Base

order number	catalog number
1873505	KPF301 BASE

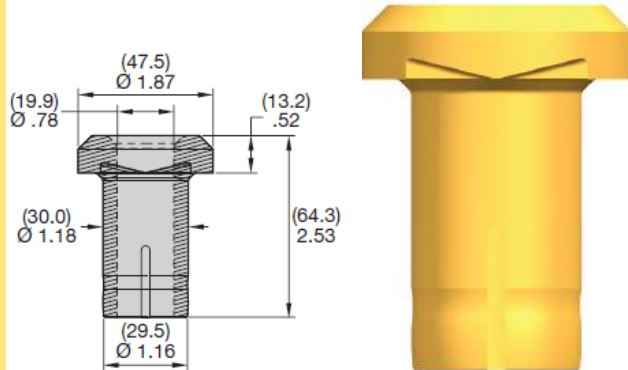
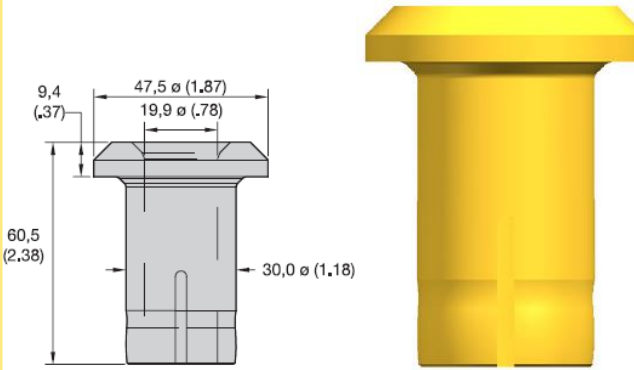

■ KPF200R Bushing

■ KPF200RP Bushing

order number	catalog number
3087915	KPF200R

order number	catalog number
6407245	KPF200RP

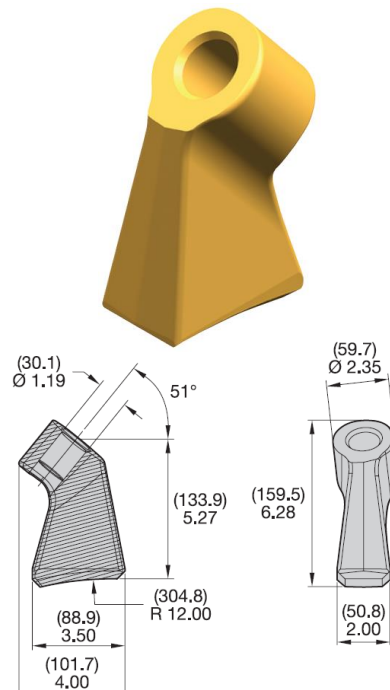
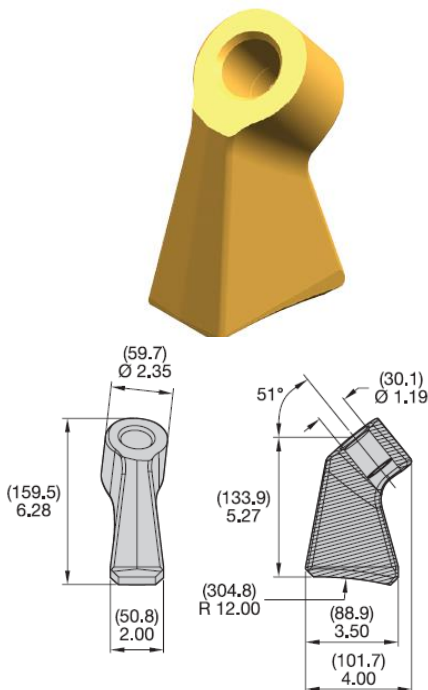



■ KPL205 Base • Left Hand

■ KPR205 Base • Right Hand

order number	catalog number
6407246	KPL205 BASE

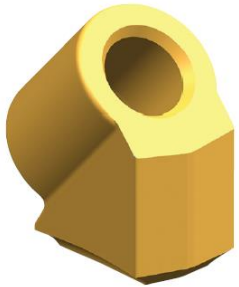
order number	catalog number
6407247	KPR205 BASE

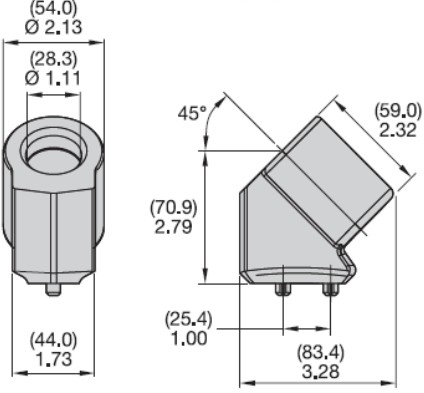
(54.0) \varnothing 2.13
 (28.3) \varnothing 1.11
 (44.0) 1.73
 45°
 (70.9) 2.79
 (25.4) 1.00
 (59.0) 2.32
 (83.4) 3.28

■ **KPF201 Block**

order number	catalog number
1971419	KPF201 BLOCK

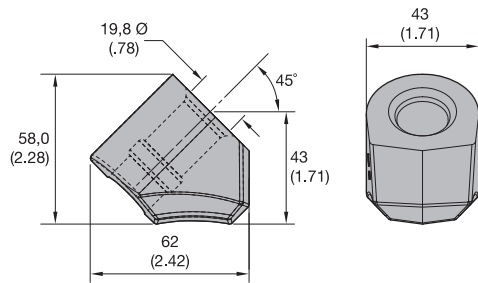

■ C10HD Block

order number	catalog number
1012289	C10HD BLOCK

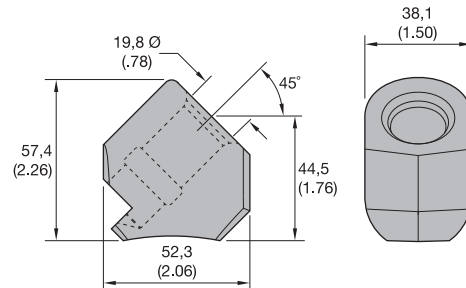

■ C10H Block

order number	catalog number
1012280	C10H BLOCK

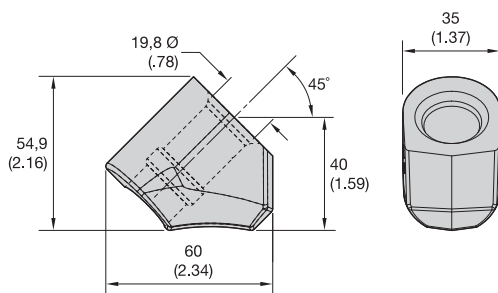

■ C10 Block

order number	catalog number
1012278	C10 BLOCK

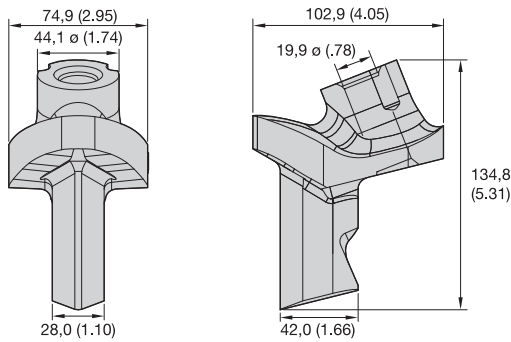
■ CB10HD Toolholder *

order number	catalog number
3484075	CB10HD BLOCK

NOTE: This product is available for sale only in the U.S.A.

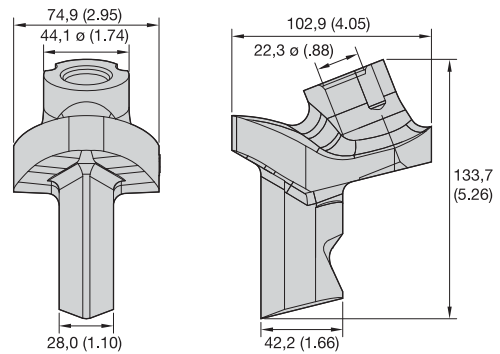
■ CB10HD-87 Toolholder *

order number	catalog number
3838604	CB10HD-87 BLOCK

NOTE: This product is available for sale only in the U.S.A.

■ CB10HD Plastic Cap

order number	catalog number
3479742	CB10HD PLASTIC CAP

NOTE: This product is available for sale only in the U.S.A.

■ CB10HD Retaining Screw

order number	catalog number
3479793	CB10HD RETAINING SCREW

NOTE: This product is available for sale only in the U.S.A.

■ CB10HD Seal

order number	catalog number
3781368	CB10HD SEAL

NOTE: This product is available for sale only in the U.S.A.

*Toolholder requires additional components that are sold separately.

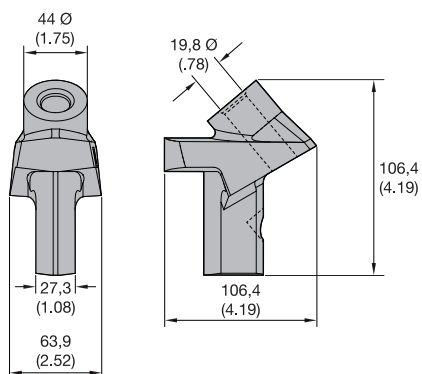

■ CB10 Toolholder *

order number	catalog number
2508113	CB10 BLOCK

NOTE: This product is available for sale only in the U.S.A.



■ CB10 Plastic Cap

order number	catalog number
2992199	CB10 PLASTIC CAP

NOTE: This product is available for sale only in the U.S.A.



■ CB10 Retaining Screw

order number	catalog number
2992200	CB10 RETAINING SCREW

NOTE: This product is available for sale only in the U.S.A.

*Toolholder requires additional components that are sold separately.

■ KIT 1HD Air Hammer

- For fast and safe tool installation.

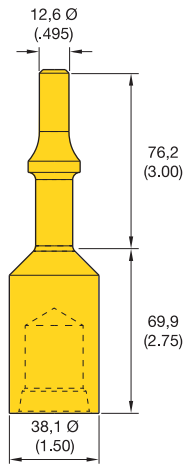

order number	catalog number
1012244	KIT 1HD AIR HAMMER

■ KPF300AHP 1HD Air Hammer Punch

- For use with KPF300 system.

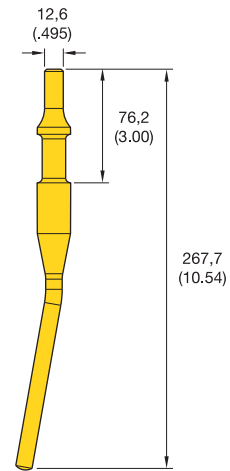

order number	catalog number
1850981	KPF300AHP 1HD

■ KAHP 1HD Air Hammer Punch

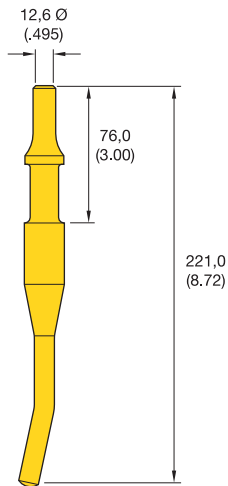

order number	catalog number
1012246	KAHP 1HD AIRHAMMER PUNCH



■ KIT 1 Air Hammer

- For fast and safe tool installation.

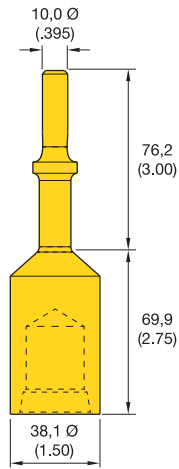

order number	catalog number
1012243	KIT 1 AIR HAMMER

■ KAHP 1 Air Hammer Punch

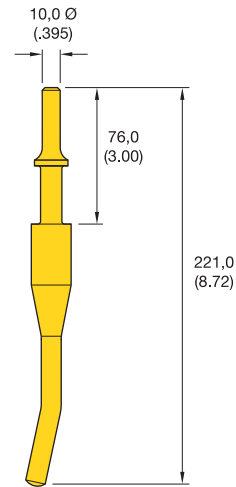

order number	catalog number
1012245	KAHP 1 AIR HAMMER PUNCH

■ KPF300 1 Air Hammer Punch

- For use with KPF300 system.

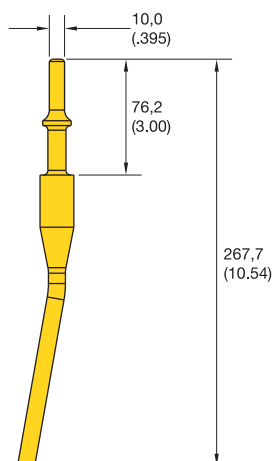

order number	catalog number
1851015	KPF300AHP1

■ KPF300CH Removal Tool

- Drives teeth out from KPF300 system.
- Wedges between tool and holder for easy tool removal.

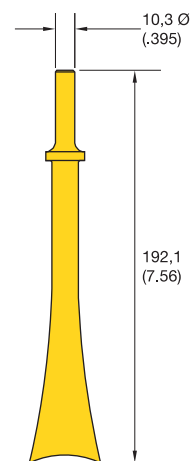

order number	catalog number
2427191	KPF300CH REMOVAL TOOL

Accessories

■ KHP2 Hammer Punch

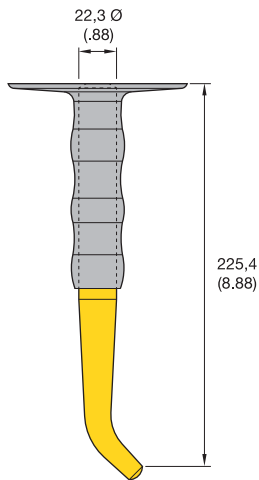

order number	catalog number
1012247	KHP2 KMTL PUNCH

■ KHP3 Hammer Punch

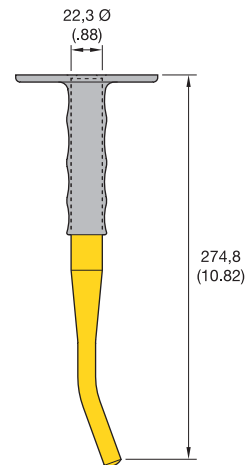

order number	catalog number
1782456	KHP3

■ KPF300H Hammer Punch

- For use with KPF300 system.

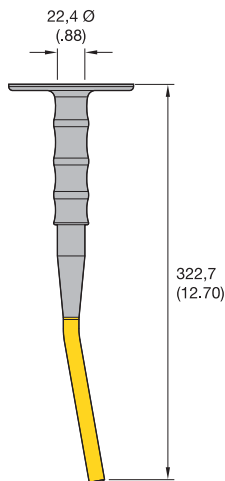

order number	catalog number
1851016	KPF300HP

■ KPF Installation Bit

- For installation of KPF200 and KPF300 system bushings and sleeves.

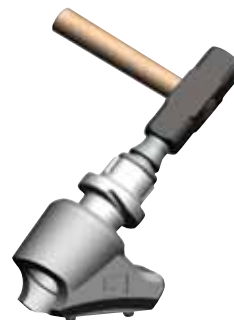

order number	catalog number
1968708	KPF-INSTL BIT

■ KPF301 SHP Wedge Starter

- Starter to remove sleeves from KPF300 system.
- Tough polyurethane padding reduces metal spalling during normal use.

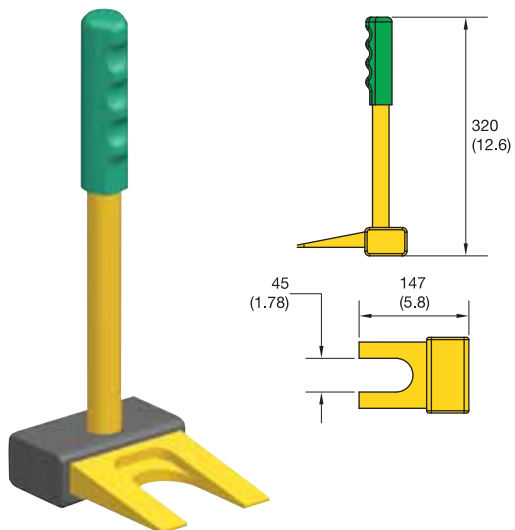

order number	catalog number
3395861	KPF301 SHP WEDGE PULLER

■ KPF301 LGP Wedge Finisher

- Finisher to remove sleeves from KPF300 system.
- Tough polyurethane padding reduces metal spalling during normal use.

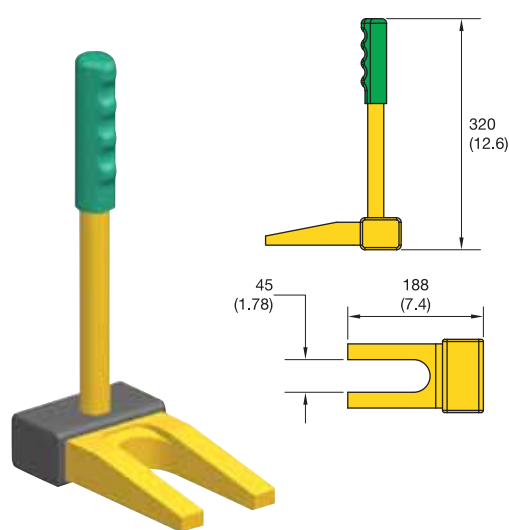

order number	catalog number
3395860	KPF301 LGP WEDGE PULLER

■ U70 Wedge Puller with Pad

- Drives teeth out from KPF300 system.
- Wedges between tool and holder for easy tool removal.



order number	catalog number
3043394	U70 PAD COATED PULLER

■ KPF XTRACTOR

- Drives bushings and sleeves out from KPF200 and KPF300 systems.

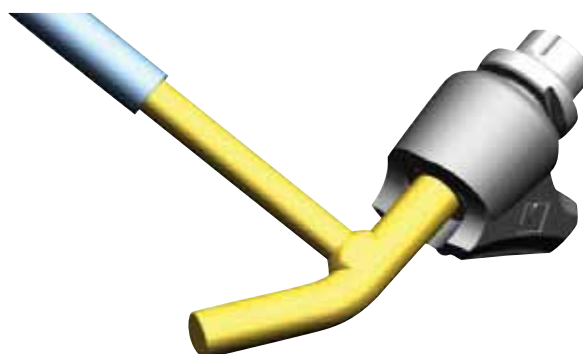

order number	catalog number
1889501	KPF XTRACTOR

Accessories

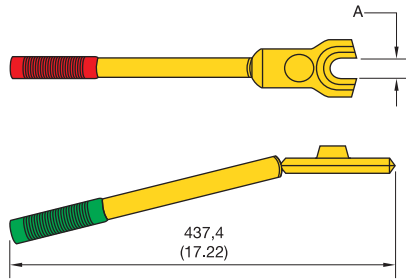
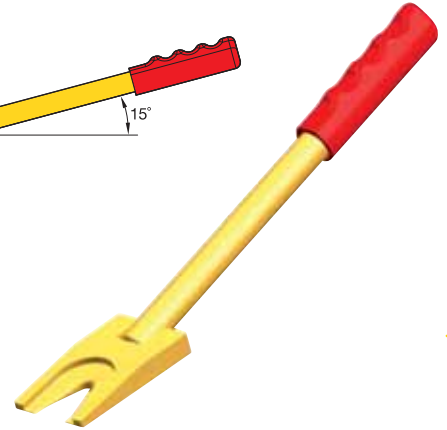
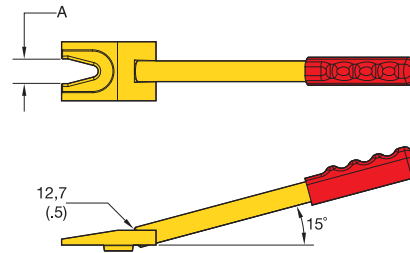
■ Hammer-Type Pullers for Removal of Cutting Tools

■ ECO Puller

order number	catalog number	series	A dimension
4141936	ECO PULLER	ECO Pro	27,0 (1.06)
1761401	RP BIT PULLER ASSEMBLY	RZ, RC	26,0 (1.02)
1012016	C123/U50 HAMMER PULLER	RS, RL, SM, SL	23,1 (.91)

Dimensions shown in millimeters and (inches).



Selecting the Right Tool

When selecting a tool, consider the material to be cut as well as the machine horsepower. If you want better strength, wear, or penetration:

- Increase the carbide tip base diameter for better strength and wear resistance.
- Decrease the carbide tip base diameter for better penetration.
- Increase the carbide tip diameter for better strength and wear resistance.
- Decrease the carbide tip diameter for better penetration.
- Increase the carbide tip length (height) for better penetration and wear resistance.
- Decrease the carbide tip length (height) for better strength.



Understand Wear Progression

By understanding proper tooling wear progression, you can maintain optimal throughput and performance. Continued use of tooling beyond its useful life cycle can have adverse affects, such as marginal productivity, catastrophic machine failure, or costly repairs. This proper wear progression can help you:

- Increase tool utilization.
- Avoid catastrophic failure.
- Maximize cutting performance.







Optimal Wear Progression

Troubleshooting

The three categories of tool failure: abrasive wear, heat failure, and mechanical failure, each contribute to less than optimal tool performance. Wear and deterioration can be observed through cracking, crater wear, chipping, deformation, or fracture.

The chart below shows typical end-of-life tool problems, possible causes, as well as proposed solutions.

Problem	Possible Cause	Solution
 Poor Rotation	Worn toolholders	Replace worn holders
	Excess material build-up on tool	Increase water flow to drum
	Holders not properly aligned	Remove incorrect holders and correct positioning
	Excessive machine speed	Slow down machine
	Cutting too deep	Decrease cutting depth (make 2 or more passes)
 Excessive Steel Body Wear	Caused by highly abrasive material	Consider using a tip design with bigger start diameter
	High rotation speed	Reduce rotation speed (if possible) Consider using a heavier body tool
	Worn belts are not removing the material	Check and replace worn belt
 Extreme Carbide Tip Wear	Hard material (aggregate)	Consider using a larger carbide tip tool
	Heat build-up on tool	Increase coolant (water) to the drum
	High rotation speed	Reduce rotation speed (if possible)
	Cutting too deep	Decrease cutting depth (make 2 or more passes)
 Tip Fractures	Extremely hard material (aggregate)	Consider using a larger carbide tip tool
	Heat build-up on tool	Increase coolant (water) to the drum
	Poor rotation	Check for worn holders, excess material build-up on tool, etc.
		Consider doing a “warm-up” cut when starting
	Excessive machine speed	Slow down machine
	Using hard objects for tool installation	Use air hammer installation tool, rubber mallet or copper hammer